

Spark Control User Manual

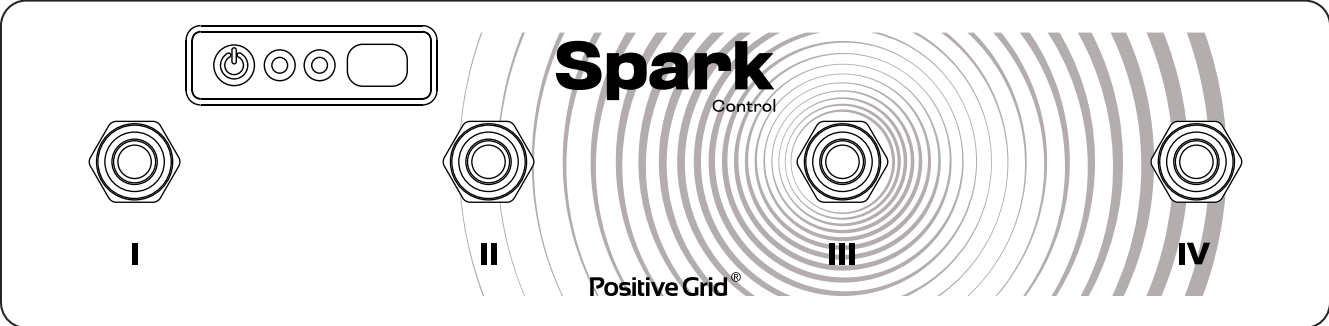

Table of Contents

02	Product Spec
03	Hardware Panel
05	Connect To Your Spark Amp Through The Spark App
06	Customize and Assign Commands
07	Selecting Footswitch Profile
08	Other Functions
08	Clear All Commands
08	Renaming Profiles
09	Deleting Profiles
09	Reset Profile Settings
10	Device Detail Page

Product Specification

POWER

MAIN INPUT POWER

DC 5V/2A, compatible with optional 9v supply

BATTERY TYPE

Built-in rechargeable lithium-ion battery

PLAY TIME

Up To 150 Hours

INCLUDED IN THE BOX

BOX CONTENTS

Spark Control
USB A to DC Plug Cable
Quick Start Guide

PHYSICAL UNIT

DIMENSIONS

248 x 70 x 45mm
(9.75 x 2.75 x 1.75 in)

WEIGHT

0.31 kgs / 0.68 lbs

CONTROLS AND CONNECTIVITY

TOP PANEL CONTROLS

4 x Steel Foot Switches
1 x Power Indicator
1 x Connection Indicator
Power Button
Function Button

REAR PANEL CONTROLS

DC Power Input

WIRELESS CONNECTIVITY

Bluetooth 5.0

TRANSMISSION RANGE

Up to 150 feet (45.7 meter) line-of-sight

Hardware Panel

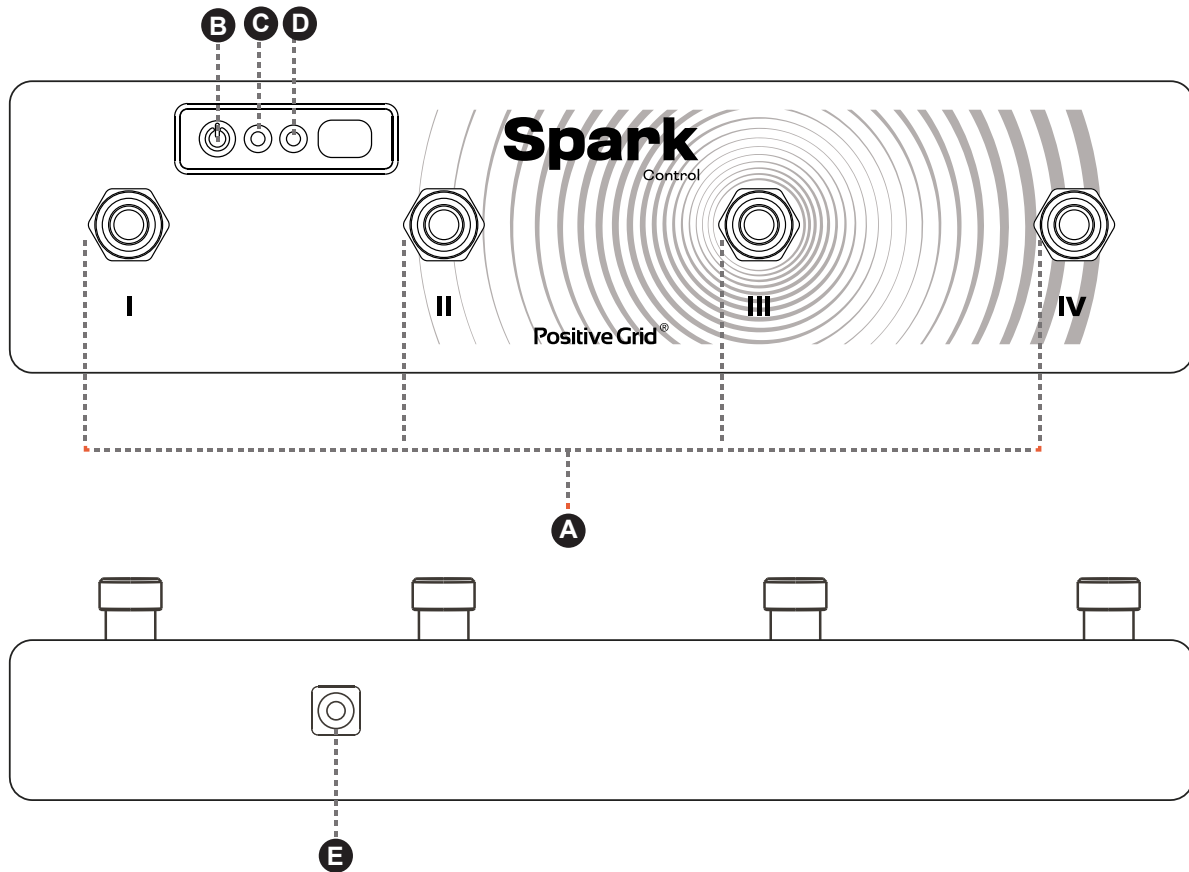

A - Footswitches

These switches control the Spark amp and specific actions can be assigned via the Spark app.

B - Power Button

Hold to turn on or off Spark Control

C - Power Indicator

Indicates power and battery status.

- Solid Red: Powered on or fully charged
- Flashing Red (Once A Second): Charging
- Flashing Red (Every 3 Second): Low Battery

D - Bluetooth Indicator

Indicates the status of the connection to your Spark amp and app.

- Solid Blue: Switch Or Power Button Pressed
- Flashing Blue (Twice A Second): Wait For Connection
- Flashing Blue (Every 3 Second): Connected

E - DC Power Input

Connect the supplied USB-A cable to charge Spark Control.

You may use a 5-9V DC power supply with center negative configuration. Charging from a laptop or a computer with a sleep setting is not recommended.

Spark App

User Guide



Connecting Spark Control to Spark Amps Through The Spark App

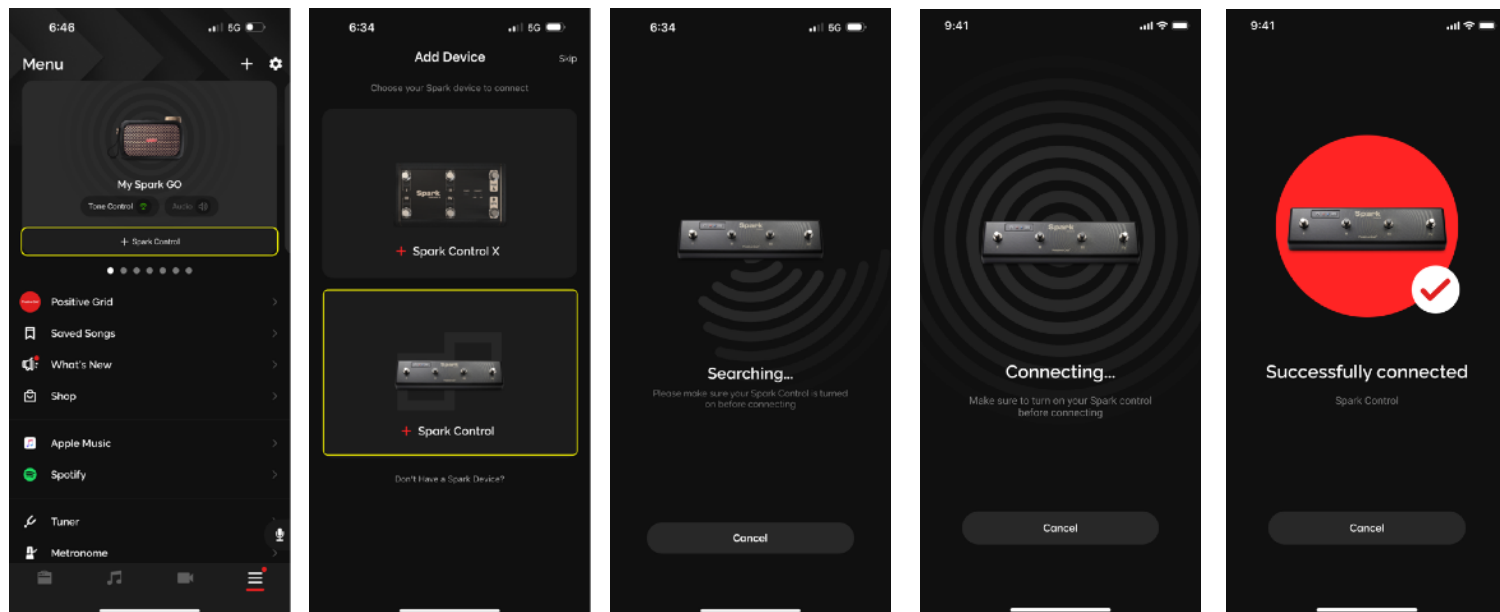

To connect Spark Control with your Spark Amps:

1. Connect your phone or tablet to your Spark amp
2. Go to the Menu and tap on "+Spark Control" on the device card
3. Ensure that your Spark Control is turned on, then tap on Spark Control on the following page to connect

Spark Control Family: Customize and Assign Commands

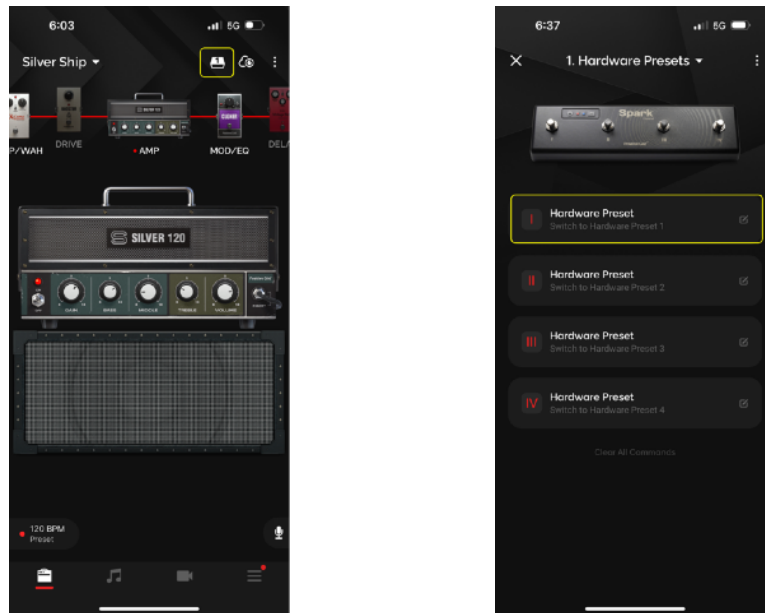

Tap on the Control Menu on the top right of the Tone Page to enter the Command Assignment Menu.
 Tip: the number shown in the icon is showing which footswitch profile number you are currently on

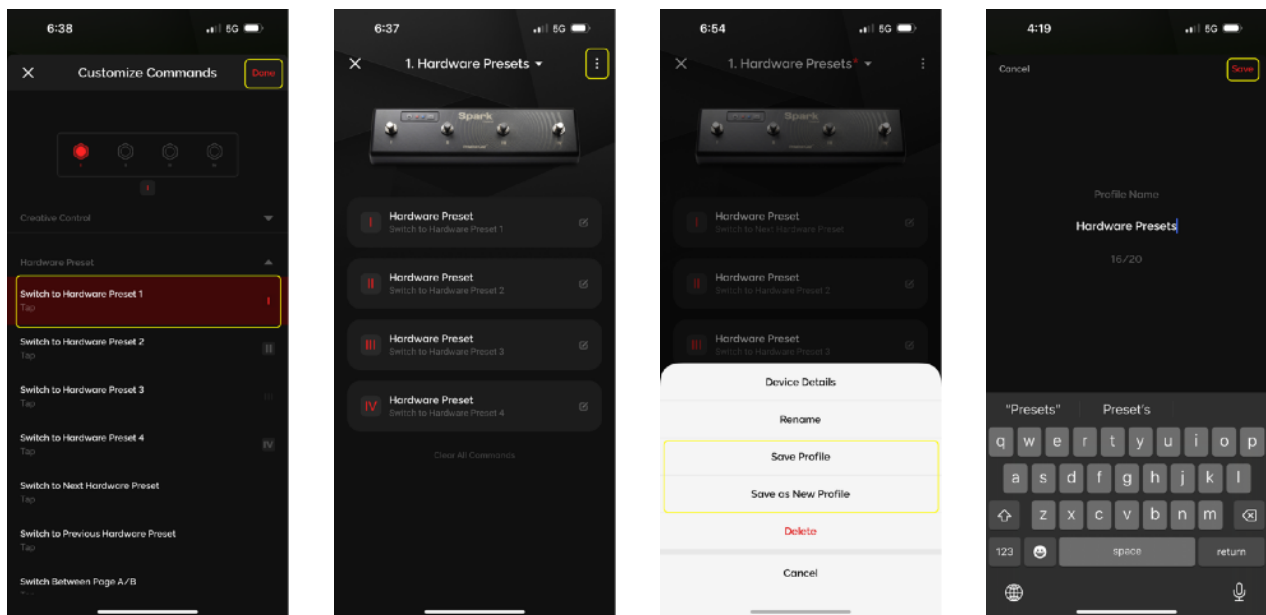

To customize which footswitch triggers which action:

1. Tap on the footswitch you would like to customize
2. Tap on a your desired action and tap Done
3. Tap on **:** and tap Save Profile (or Save as New to also name the profile) to save the setting once you've changed your footswitches to your desired actions

Spark Control Family: Selecting Footswitch Profile

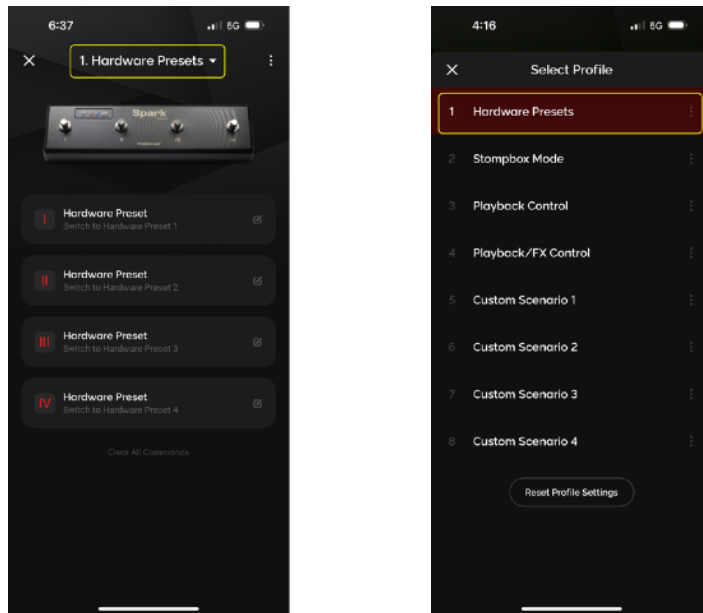

To select which footswitch profile to use, tap on the Profile Title dropdown menu on the top of the page and tap on your desired profile.

Spark Control Family: Other Functions

Clear All Commands

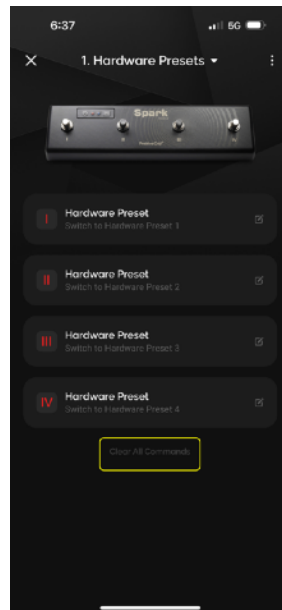

In the Command Assignment Menu, tap on Clear All Commands at the bottom to clear all assigned commands

Renaming Profiles

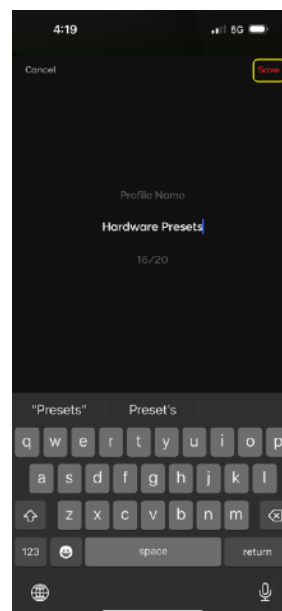
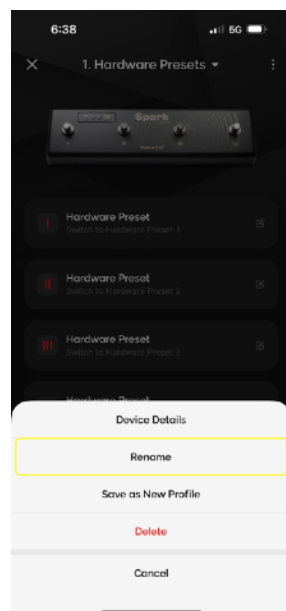

1. Tap on **:** in the Command Assignment menu, then tap on **Rename**
2. Type in the desired profile name, then tap on **“Save”** to save the naming

Spark Control Family: Other Functions

Deleting Profiles

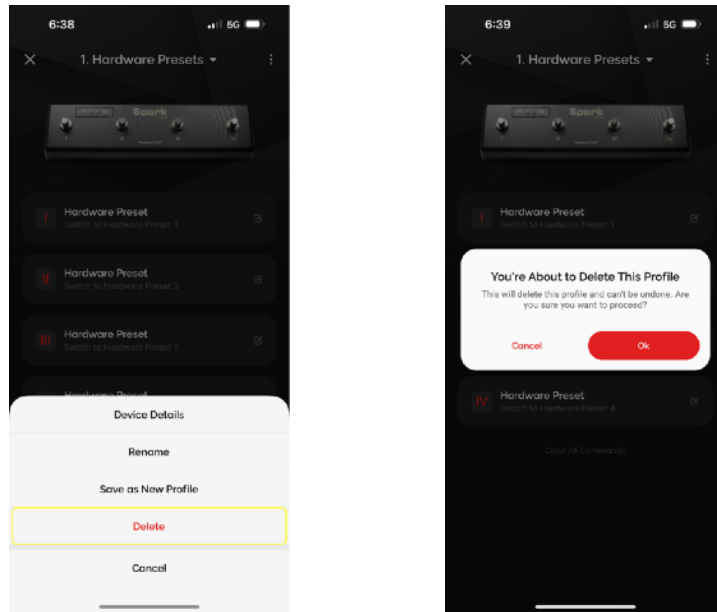

Tap on  in the Command Assignment menu, then tap on Delete and tap on Ok when the next dialog box appears to clear all commands as well as delete the name of the selected Footswitch Profile.

Reset Profile Settings

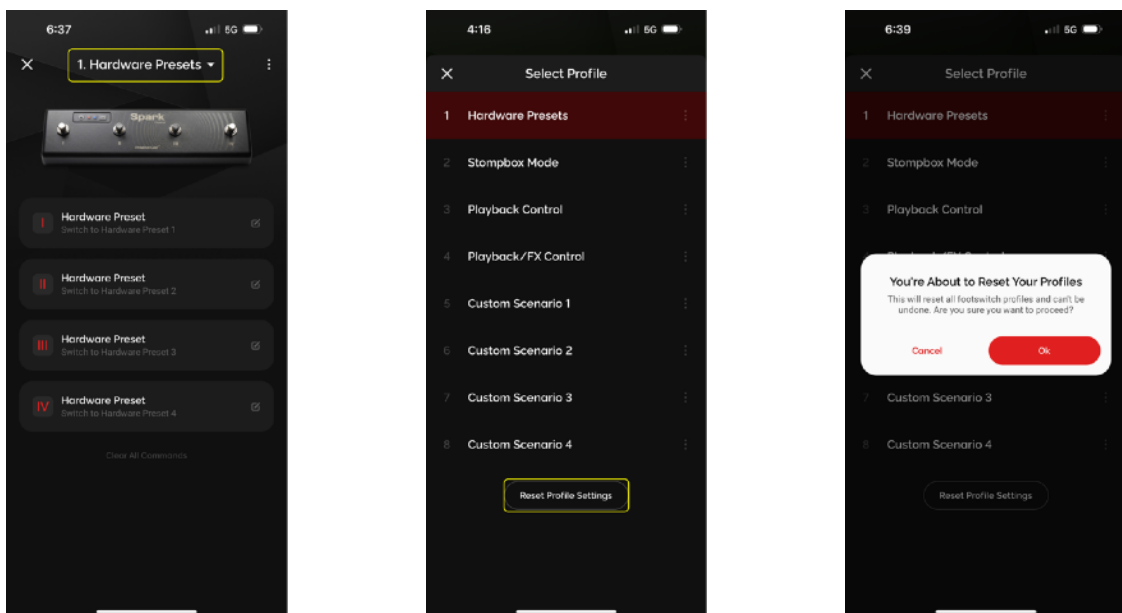

1. Tap on the Profile Title dropdown menu on the top of the page
2. Tap on Reset, then tap Ok to reset all Footswitch Profiles to the factory default settings. Note that this will also clear and reset any of your custom profiles.

Spark Control Family: Other Functions

Device Detail Page

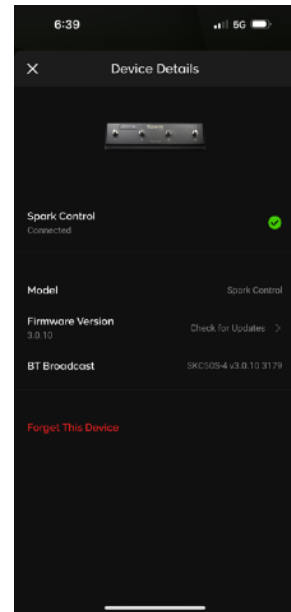
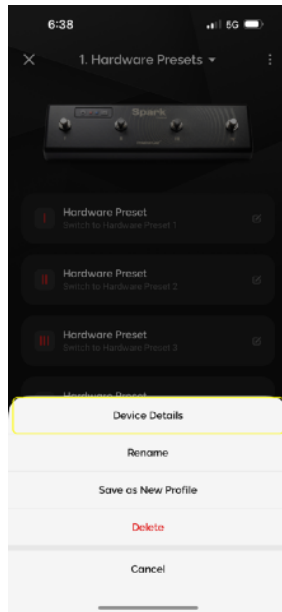
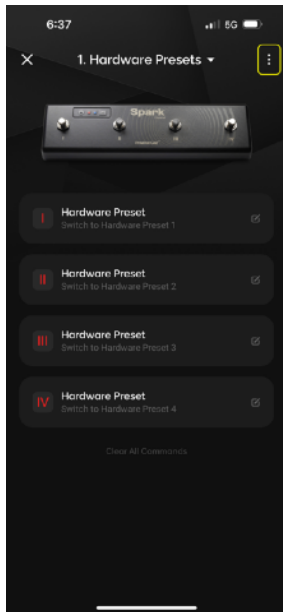

Tap on  in the Command Assignment menu, then tap Device Details to see information such as model name and firmware version