

# Spark Control X User Manual

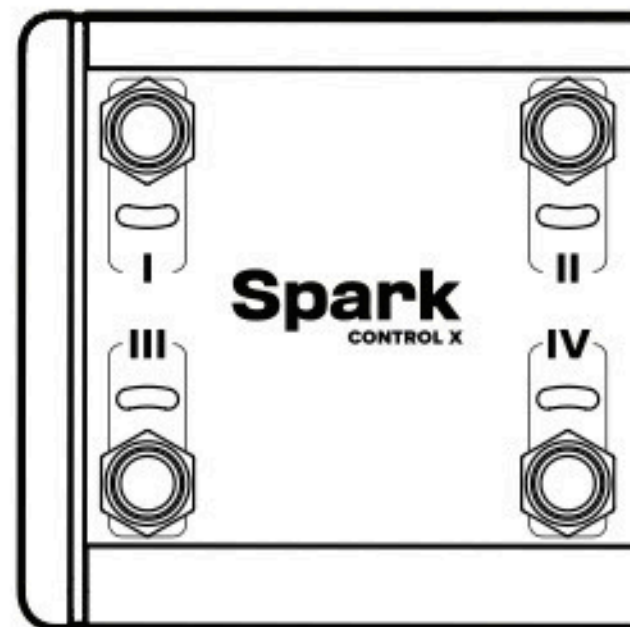

# Table of Contents

<b>02</b>	Product Spec
<b>03</b>	Hardware Panel
<b>04</b>	Connect Directly To Spark LIVE
<b>05</b>	Connect To Your Spark Amp Through The Spark App
<b>06</b>	Using The Overlay
<b>07</b>	Factory Default Profiles
<b>09</b>	Connecting Spark Control and Control X to Spark/Spark MINI/Spark GO
<b>10</b>	Customize and Assign Commands
<b>11</b>	Selecting Footswitch Profile
<b>12</b>	Expression Pedal Command Assignment
<b>12</b>	Expression Pedal Calibration
<b>13</b>	Other Functions

# Product Specification

## POWER

---

### MAIN INPUT POWER

DC 5V/2A

### BATTERY TYPE

Built-in 750mAh rechargeable lithium-ion battery

### CHARGING TIME

7.5 hours

### PLAY TIME

Up To 150 Hours

## INCLUDED IN THE BOX

---

### BOX CONTENTS

Spark Control X  
USB A to C Cable  
Overlay x 3pcs  
Quick Start Guide  
Safety Instructions Card

## PHYSICAL UNIT

---

### DIMENSIONS

Switch Excluded:

L 162.9 x W 90.9 x H 36.8 mm  
(L 6.41 x W 3.57 x H 1.44 inch)

Switch Included:

L 162.9 x W 90.9 x H 54.8 mm  
(L 6.41 x W 3.57 x H 2.15 inch)

### WEIGHT

0.45 kg / 0.99 lb

## CONTROLS AND CONNECTIVITY

---

### TOP PANEL CONTROLS

6 x Steel Foot Switches  
6 x Foot Switch Indicators  
1 x Power Indicator  
2 x Connection Indicators

### REAR PANEL CONTROLS

Power Button  
Bluetooth Button

### DEFAULT PROFILES

Profile 1 - Preset Mode (To switch the Spark amp presets)  
Profile 2 - Stompbox Mode (To toggle the effects)

### WIRED CONNECTIVITY

2 x ¼" Expression Pedal Jacks  
1 x USB-C Port

### WIRELESS CONNECTIVITY

Bluetooth 5.0

### TRANSMISSION RANGE

Up to 55 feet (17 meter) line-of-sight

# Hardware Panel

## Main Panel

---

### Footswitches

These switches control the Spark amp and specific actions can be assigned via the Spark app.

### Footswitch Indicators

Indicates the status and other functions (such as BPM) of the assigned command.

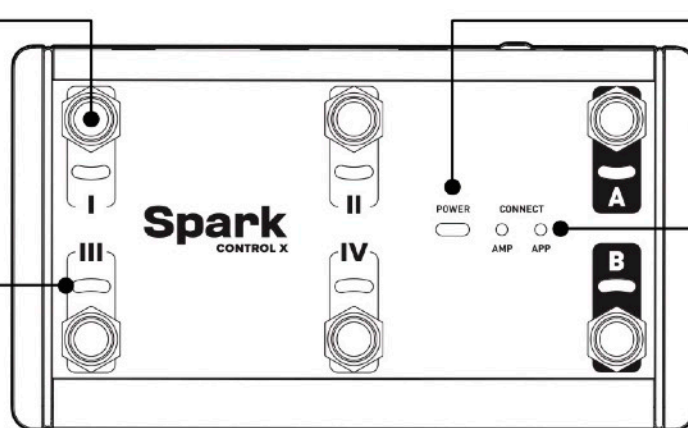

### Power Indicator

Indicates power and battery status.

- Solid Green: Powered on or fully charged
- Solid Red: Low battery
- Flashing Green/Red: Charging

### Connection Indicators

Indicates the status of the connection to your Spark amp or app.

- Solid Blue: Connected
- Flashing Blue: Pairing

## Rear Panel

---

### Bluetooth® Pair Button

Press to enter Bluetooth® pairing mode when connecting to your Spark amp.

### Power Button

Hold to turn on or off Spark Control X.

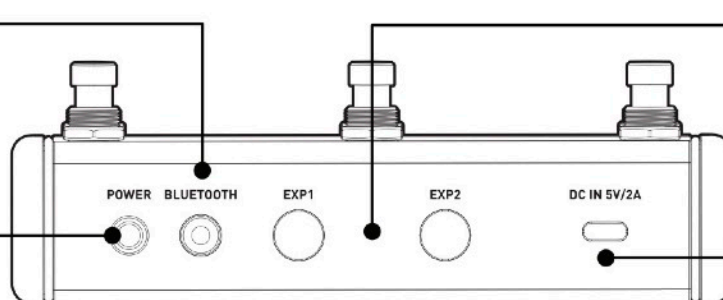

### Expression Pedal inputs

Connect expression pedals here to control Wah pedals, volume or any other effects in the Spark app.

\*Compatible with TRS type expression pedals. Configuration can be done in the Spark app.

### USB-C® Charging Port

Connect the supplied USB-C® to USB-A cable to charge Spark Control X.

## Connect Directly To Spark LIVE

Connect Spark Control X directly to your Spark LIVE for quick and easy wireless control.

---

- **Step1.** Turn on the Spark LIVE and Spark Control X

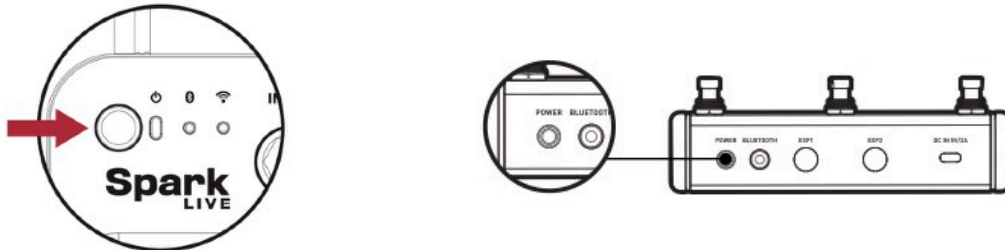

- **Step2.** Long press the Pair Button on the Rear Panel until both Wireless Indicator LEDs on the Front Panel light up.

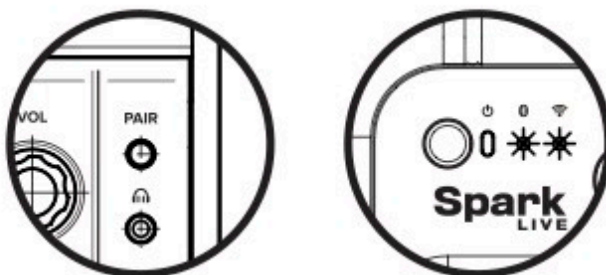

- **Step3.** Spark LIVE will automatically connect to the Spark Control X.

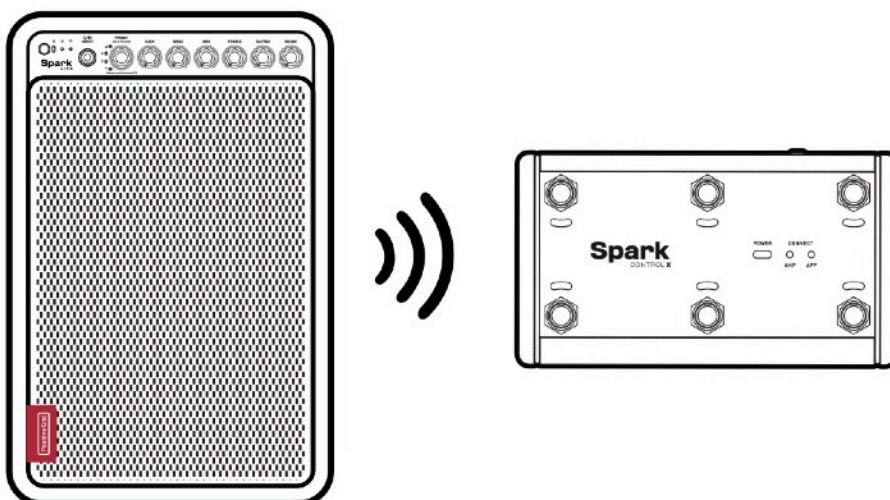

## Connect To Your Spark Amp Through The Spark App

To take full advantage of all the customization options of Spark Control X, we recommend connecting through the Spark app.

---

- **Step1.** Turn on your Spark amp, Spark Control X, and launch the Spark app on your mobile device.

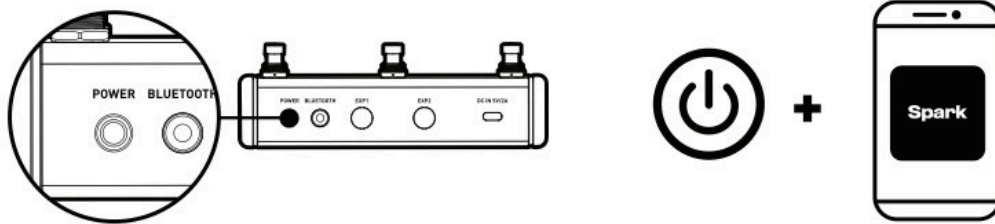

- **Step2.** Tap "+Spark Control" in the device menu of the Spark app and it will walk you through connecting your Spark Control X.
- **Step3.** You can now customize the switches on your Spark Control X through the Spark app.

*\* If you are connecting to a Spark 40, Spark MINI, or Spark GO, you must connect Spark Control X through the Spark app.*

## Using The Overlays

---

Spark Control X comes with 3 transparent Overlays that can be used to label functions assigned to the footswitches and can be swapped easily. You may also use a marker to make any other notes or diagrams on the Overlays.

If using a dry erase marker, you can clean an Overlay by simply using a tissue or wiping cloth. If using a permanent marker, first remove the Overlay and wipe it down with an alcohol soaked tissue or wiping cloth.

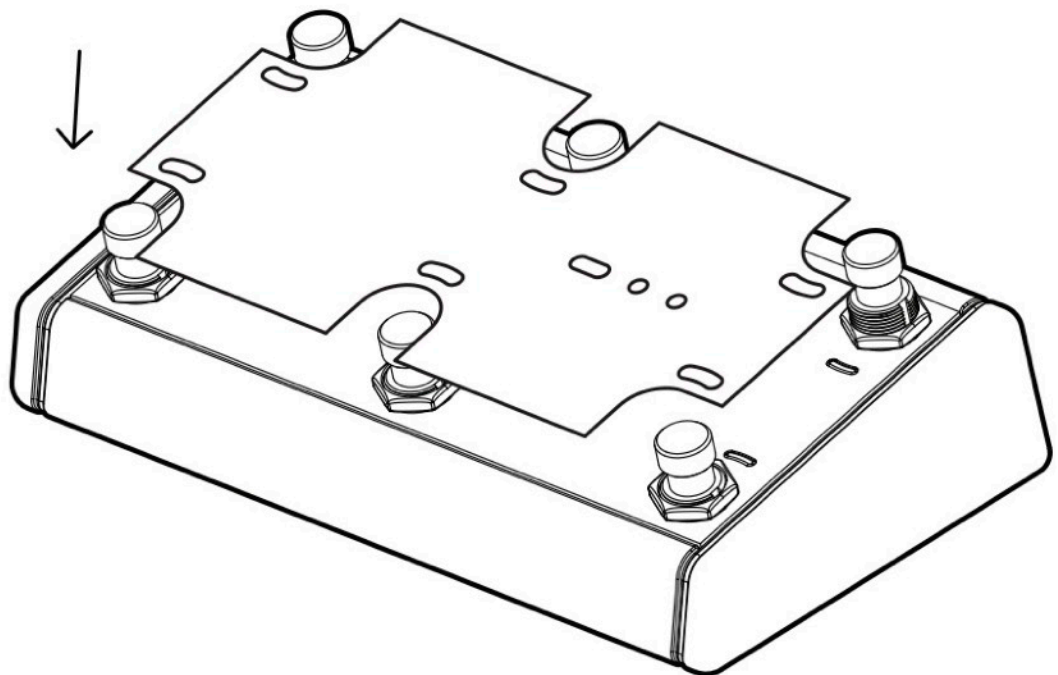

## Factory Default Profiles

Spark Control X comes with a few pre-programmed profiles that are designed for players to use right out of the box. You can also edit the current profiles or add more profiles from the Spark App.

---

### Profile 1

Spark amps \ Foot Switches	Switch 1	Switch 2	Switch 3	Switch 4	Switch A	Switch B	Exp. Pedal 1	Exp. Pedal 2
Spark LIVE	Switch To Preset 1	Switch To Preset 2	Switch To Preset 3	Switch To Preset 4	Switch Preset Page (Red/Green)	Switch To Next Preset	Input1 Guitar Volume	Music Volume
Spark 40	Switch To Preset 1	Switch To Preset 2	Switch To Preset 3	Switch To Preset 4	Switch To Previous Preset	Switch To Next Preset	Guitar Volume	
Spark MINI and Spark GO	Switch To Preset 1 (Rhythm)	Switch To Preset 2 (Lead)	Switch To Preset 3 (Solo)	Switch To Preset 4 (CusTom)	Switch To Previous Preset	Switch To Next Preset	Guitar Volume	

### Profile 2

Spark amps \ Foot Switches	Switch 1	Switch 2	Switch 3	Switch 4	Switch A	Switch B	Exp. Pedal 1	Exp. Pedal 2
Spark LIVE	Toggle Gate On/Off	Toggle Comp/Wah On/Off	Toggle Drive On/Off	Toggle Mod/EQ On/Off	Toggle Delay On/Off	Toggle Reverb On/Off	Input1 Guitar Volume	
Spark 40, Spark MINI, and Spark GO	Toggle Gate On/Off	Toggle Comp/Wah On/Off	Toggle Drive On/Off	Toggle Mod/EQ On/Off	Toggle Delay On/Off	Toggle Reverb On/Off	Guitar Volume	

### Global Controls

Spark amps \ Foot Switches	Switch 1	Switch 2	Switch 3	Switch 4	Switch A	Switch B	Exp. Pedal 1	Exp. Pedal 2
Spark LIVE					Long Press To Switch To Previous Profile	Long Press To Switch To Next Profile		

# **Spark App**

# **User Guide**



## Connecting Spark Control and Control X to Spark/MINI/GO

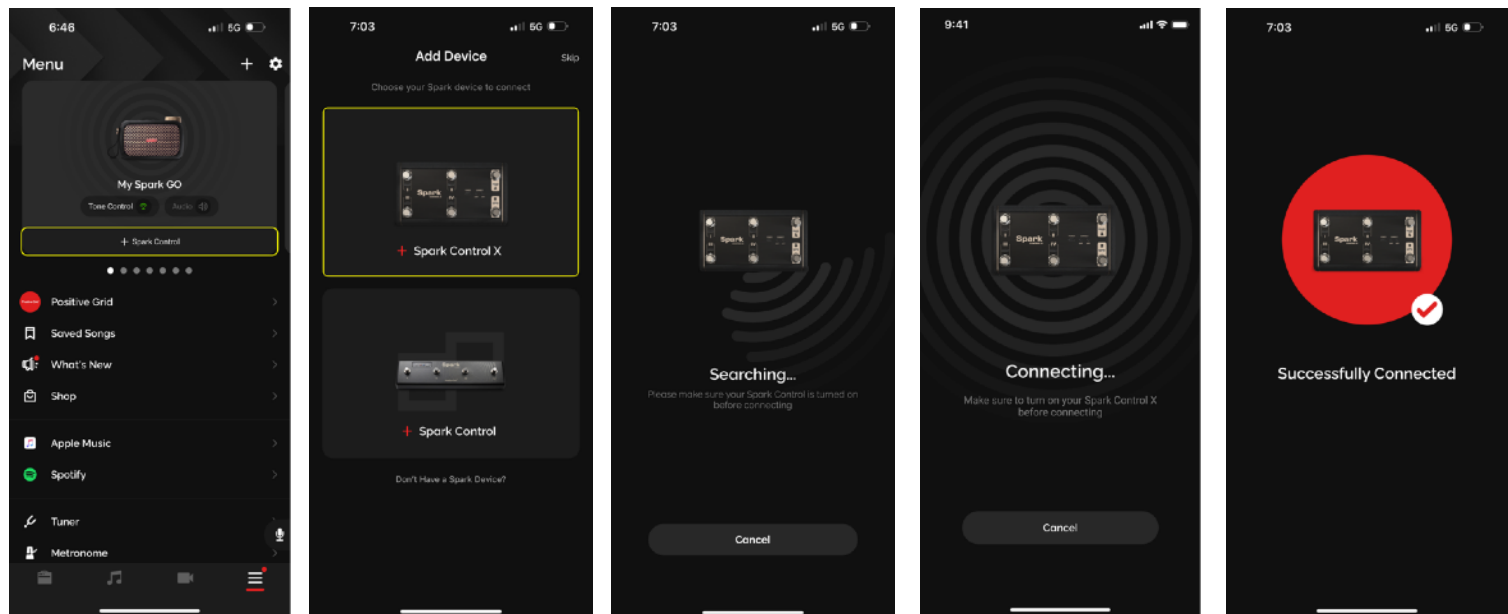

To connect Spark Control or Control X with your Spark/MINI/GO (Control X will be used moving forward):

1. Connect your phone or tablet to your Spark amp
2. Go to the Menu and tap on "+Spark Control" on the device card
3. Ensure that your Control X is turned on, then tap on Control X on the following page to connect

## Spark Control Family: Customize and Assign Commands

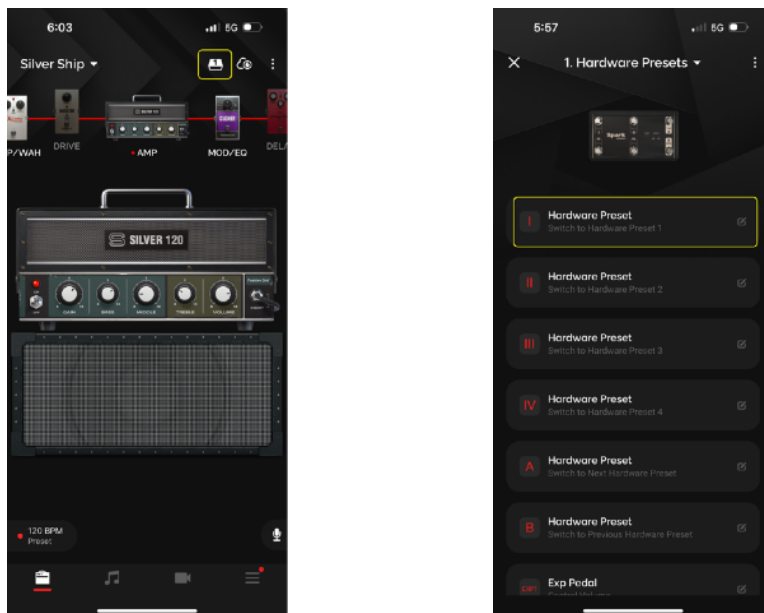

Tap on the Control Menu on the top right of the Tone Page to enter the Command Assignment Menu.  
Tip: the number shown in the icon is showing which footswitch profile number you are currently on

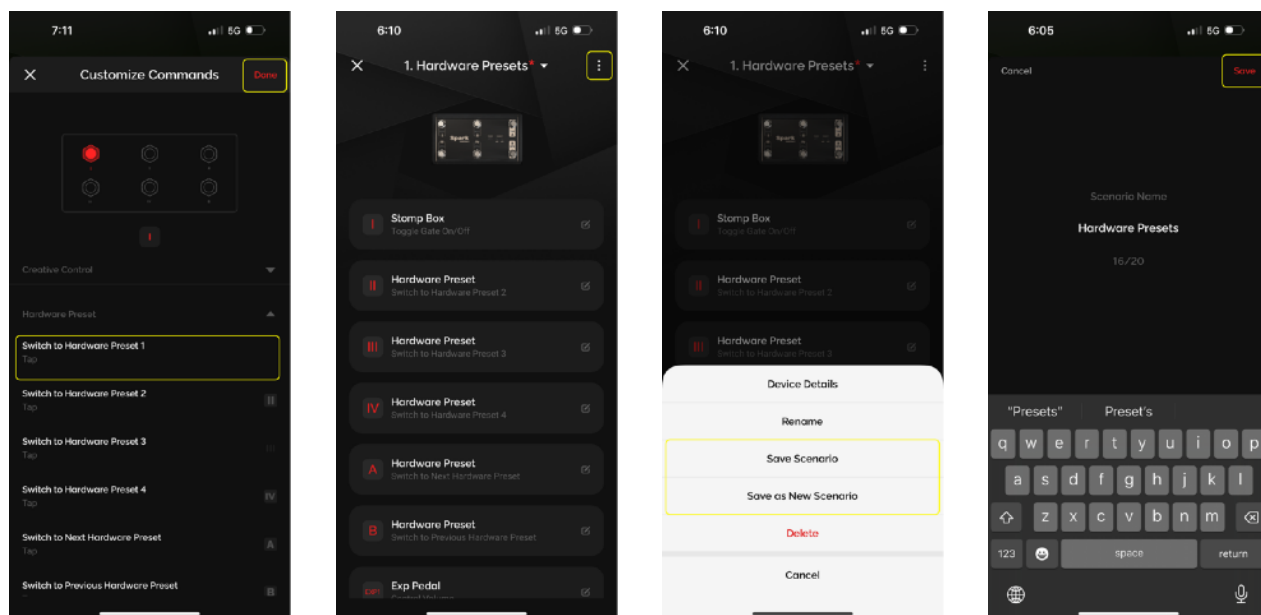

To customize which footswitch triggers which action:

1. Tap on the footswitch you would like to customize
2. Tap on a your desired action and tap Done
3. Tap on and tap Save Profile (or Save as New to also name the profile) to save the setting once you've changed your footswitches to your desired actions

## Spark Control Family: Selecting Footswitch Profile

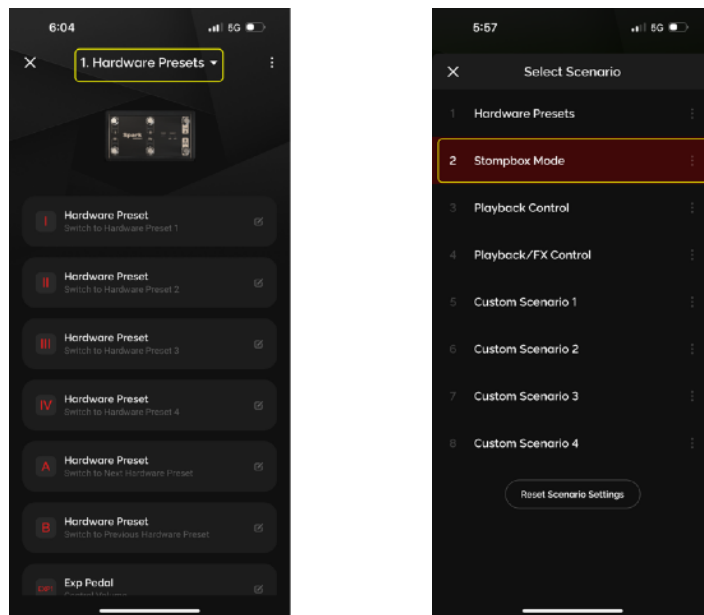

To select which footswitch profile to use, tap on the Profile Title dropdown menu on the top of the page and tap on your desired profile.

## Spark Control X: Expression Pedal Command Assignment

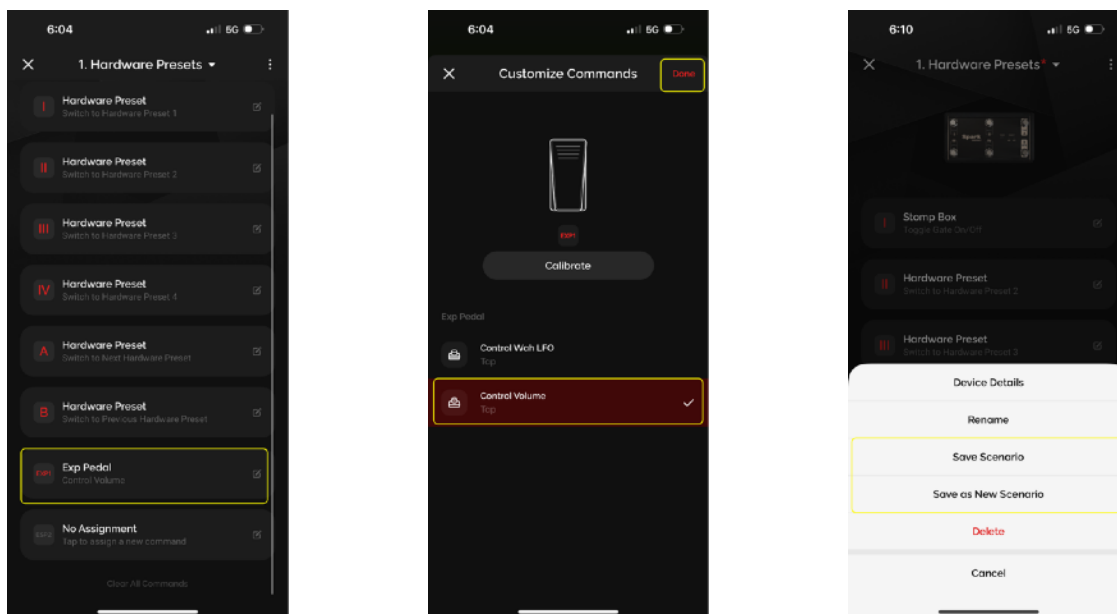

Spark Control X supports Expression Pedal inputs to control certain actions

To assign a command to connected expression pedals:

1. In the Command Assignment Menu, scroll down and tap on the EXP1 or EXP2 command slots
2. Tap on a command to assign the command to that expression pedal slot
3. Tap on and tap Save Profile to save the setting once you've finished customizing your commands

## Spark Control X: Expression Pedal Calibration

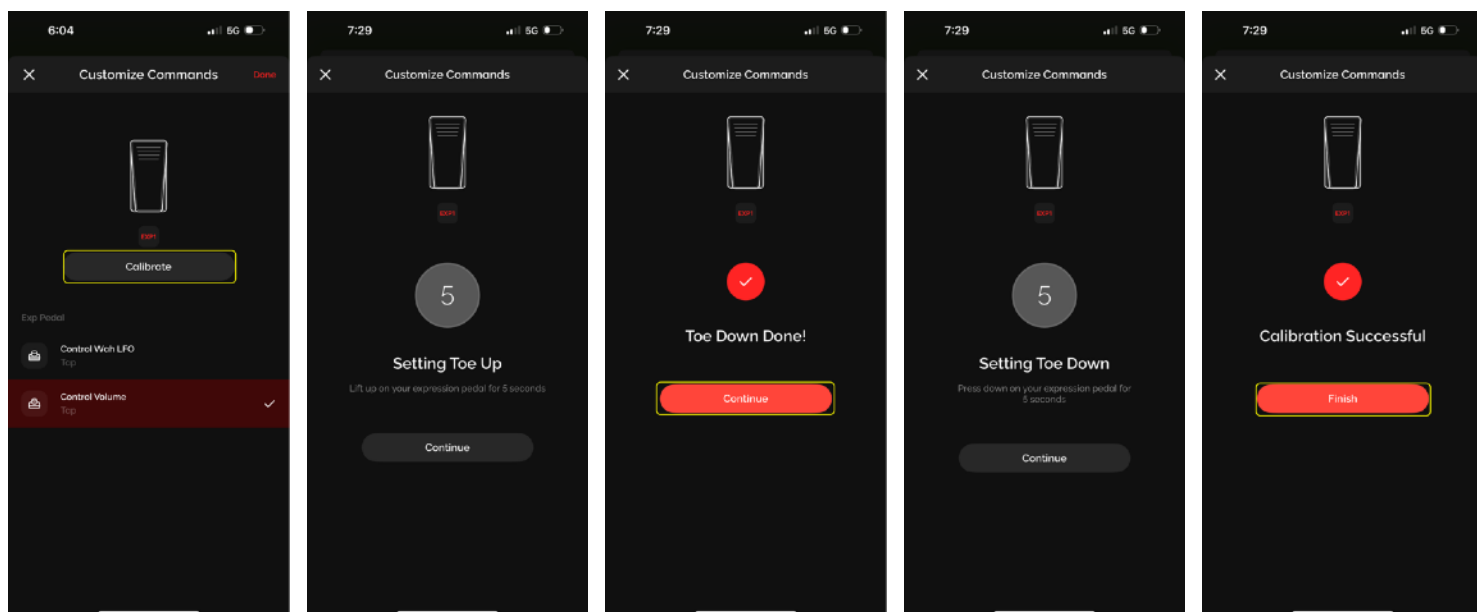

Some expression pedals may require calibration to get the full range of motion of the pedal. To calibrate your expression pedal:

1. In the Command Assignment Menu, scroll down and tap on the EXP1 or EXP2 command slots
2. Tap on Calibrate to start the calibration process
  - (A) Depress the expression pedal during Toe Down for 5 seconds, then tap Continue
  - (B) Raise the expression pedal during Toe Up for 5 seconds
  - (C) Tap on finish to finish calibration

# Spark Control Family: Other Functions

## Clear All Commands

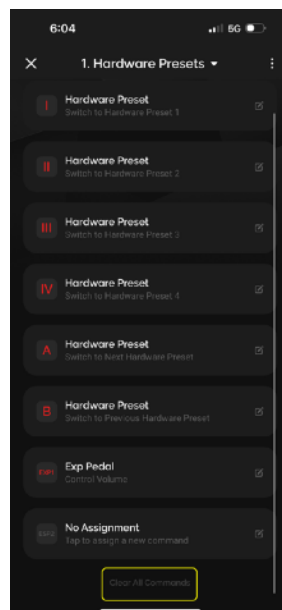

In the Command Assignment Menu, tap on Clear All Commands at the bottom to clear all assigned commands

## Renaming Profiles

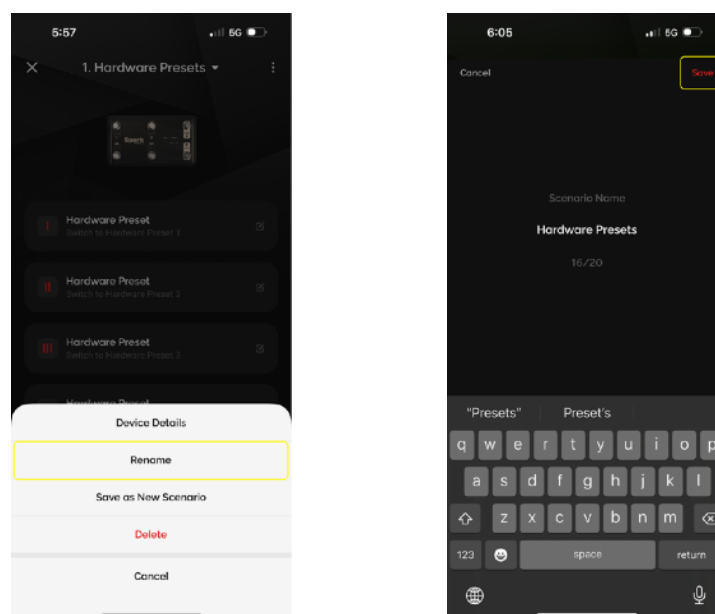

1. Tap on  in the Command Assignment menu, then tap on Rename
2. Type in the desired profile name, then tap on "Save" to save the naming

# Spark Control Family: Other Functions

## Deleting Profiles

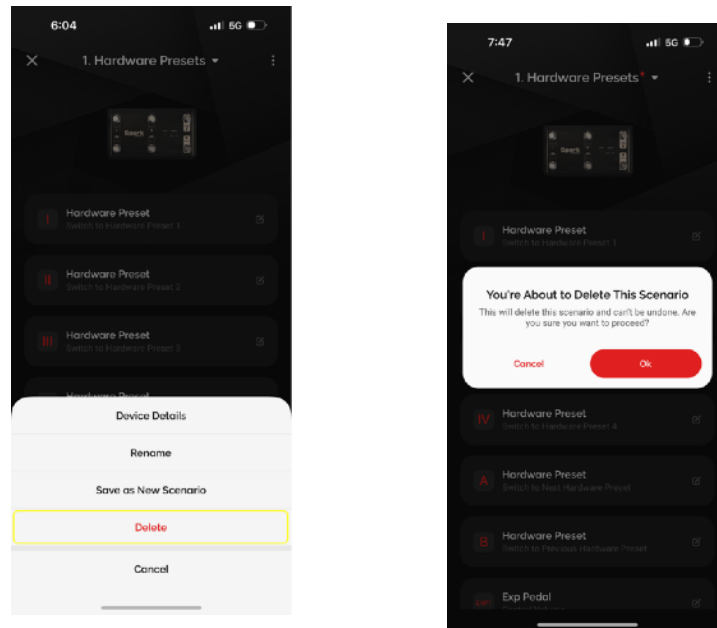

Tap on  in the Command Assignment menu, then tap on Delete and tap on Ok when the next dialog box appears to clear all commands as well as delete the name of the selected Footswitch Profile.

## Reset Profile Settings

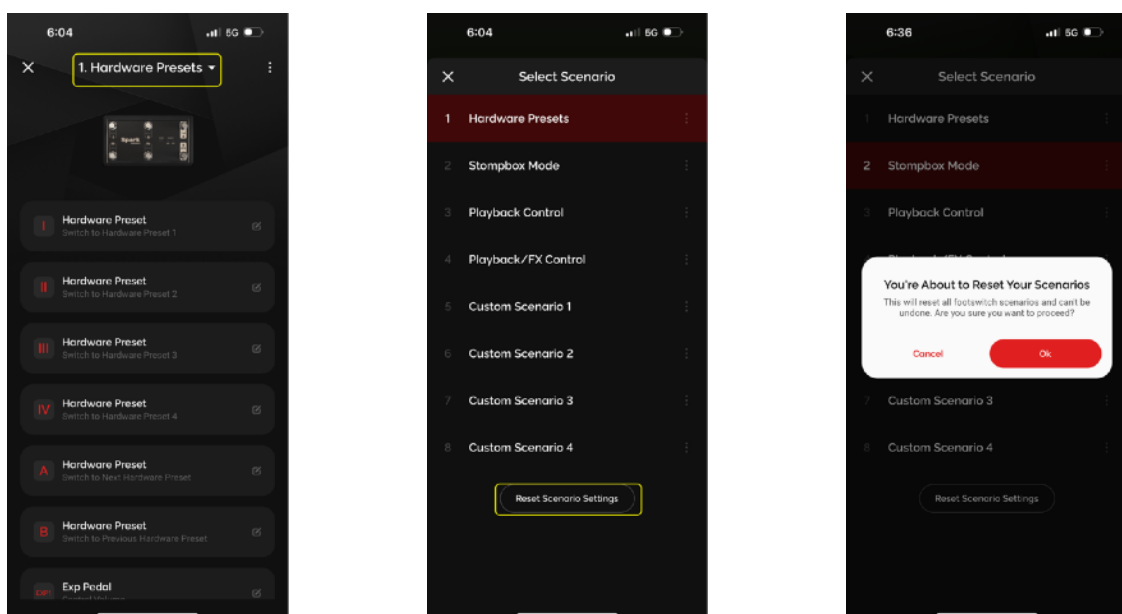

1. Tap on the Profile Title dropdown menu on the top of the page
2. Tap on Reset, then tap Ok to reset all Footswitch Profiles to the factory default settings. Note that this will also clear and reset any of your custom profiles.

# Spark Control Family: Other Functions

## Device Detail Page

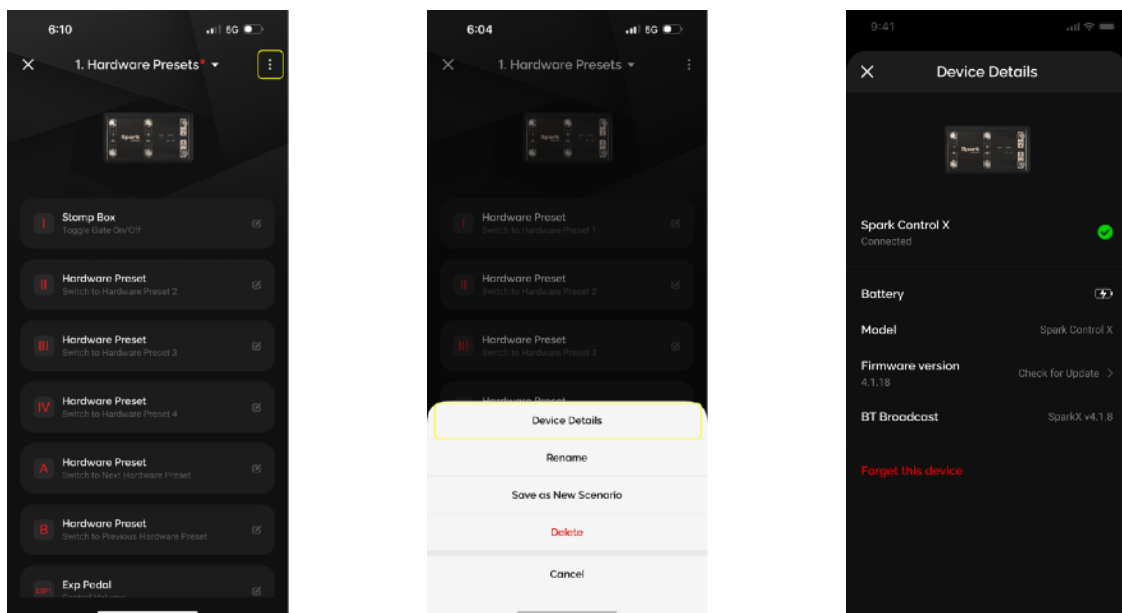

Tap on  in the Command Assignment menu, then tap Device Details to see information such as battery status and firmware version

## Control X: Updating Firmware

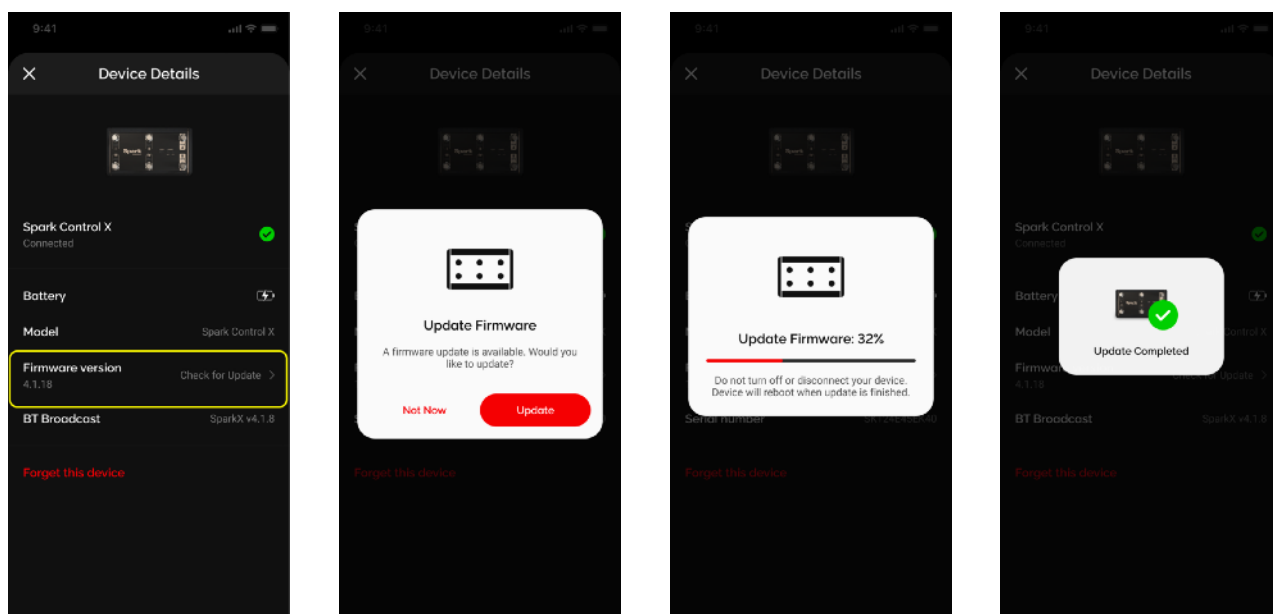

1. In the Device Detail Page of the connected Control X, tap on Check for Update
2. If an update is available, a dialog will appear to confirm whether you would like to update the firmware. Tap on Update to begin the update process.
3. Once the update is complete, a dialog box will appear indicating that the firmware update is complete. Your Control X will turn off and install the firmware update. Keep the Control X off for 30 seconds to allow it to install the firmware, then turn it on and reconnect the device.