

Spark LIVE

# User Manual

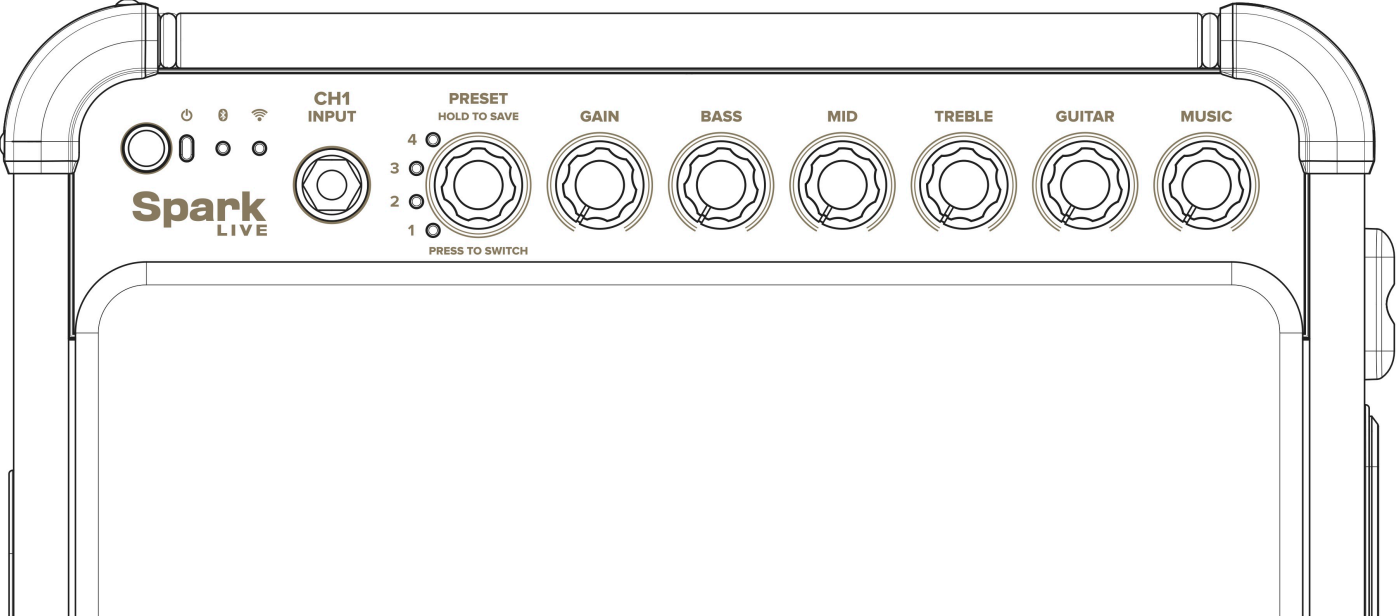

# Table of Contents

- 03** Product Spec
- 05** Hardware Control (Front)
- 07** Hardware Control (Rear)
- 10** To play music via Bluetooth®
- 11** Using The Tilt Stand
- 12** G-Sensor
- 13** Mounting Spark LIVE on a Speaker Stand
- 14** Installing Battery
- 15** Pairing With A Spark Control X
- 16** Tuner Mode
- 17** Factory Default Settings
- 18** MIDI In Settings
- 19** Factory Reset / Force Shutdown & Restart
- 21** App Connection
- 22** Log In to Your Positive Grid Account
  - 23** Manage Your Profile
- 24** Adjusting Effects and Presets
- 25** Mixer View
- 26** Exploring the ToneCloud®
  - 26** Search and Preset Actions
  - 27** Share Your Own Presets to the ToneCloud
  - 28** Explore Other's Profiles
- 29** Using Smart Jam
  - 30** Playing With Dave/Sharon/Charles
  - 32** Playing With Jarvis
  - 33** Saving a Backing Track
  - 34** Starting a Quick Jam
- 35** Using Auto Chords and Tones
- 36** Connecting Spotify and Apple Music
- 37** Using Video Recording

# Table of Contents

- 38** Using Voice Command
- 39** Device Card and Adjustments (Bluetooth Settings, Power Settings and more)
- 40**     Updating Your Firmware on the Spark LIVE
- 41** Other Available Functions
- 41**     Tuner and Metronome
- 42** Online Support

# Product Specification

## AUDIO SPECIFICATIONS

---

### FREQUENCY RANGE

45-20000 Hz

### STEREO/MONO

STEREO

### MAXIMUM SOUND PRESSURE LEVEL

RMS : 118 dB SPL @ 1m

Peak : 121 dB SPL @ 1m

### CABINET PRINCIPLE

Bass Reflex

### POWER AMPLIFIERS

150W RMS / 450W Peak, Class D Amplifier

### SPEAKERS

2 x 1 inch Compression Tweeter with Custom Angled Horn

2 x 6.5 inch Custom Designed Woofer

2 x Reflex Port

### TOTAL IMPEDANCE

4 ohms

## POWER

---

### MAIN INPUT POWER

AC 100~240V

### USB-C POWER OUTPUT (Charging Port)

DC 5V/1.5A

### BATTERY TYPE (Spark Battery)

Detachable 6,000 mAh rechargeable lithium-ion battery

(Spark Battery sold separately.)

### CHARGING TIME

3 hours

### PLAY TIME

Up To 8 Hours (on mid volume)

## INCLUDED IN THE BOX

---

### BOX CONTENTS

Spark LIVE Amplifier

USB A to C Cable

Power Cord (2M)

Quick Start Guide

Safety Instructions Card

## CONTROLS AND CONNECTIVITY

---

### FRONT PANEL CONTROLS

Power Button

Channel 1 Eight Programmable Preset Selector

Channel 1 Amp Controls (Gain, Bass, Mid,

Treble, Master

Channel 1 Volume

Music Channel Volume

### REAR PANEL CONTROLS

Pair Button

Channel 2 Eight Programmable Preset Selector

Channel 2 Volume

Channel 3&4 Volume

Center-click Master Controls (Low, Mid, High,

Volume)

### COMPUTATIONAL AUDIO

Sonic IQ Computational Audio

Dedicated Computational Audio Chip

Dynamic Range Compression

Bass & Vocal Enhancement

Stereo Widening

Auto EQ

### ONBOARD EFFECTS

Channel 1:

33 Amp Models (For electric guitar, acoustic guitar, bass)

43 Effects (Noise Gate, Compressor, Distortion, Modulation/EQ, Delay, Reverb)

Choose up to 3 pre-amp effects, 3 post amp effects, and 1 amp model for each preset

Channel 2:

3 Amp Models (For vocal, bass & acoustic guitar)

50 Effects (Noise Gate, Compressor, Distortion, Modulation/EQ, Delay, Reverb)

Choose up to 1 pre-amp effects, 2 post amp effects, and 1 amp model for each preset

### WIRED CONNECTIVITY

1/4" Instrument Input x 3

XLR / 1/4" Combo Input x 1

1/8" Headphone Output x 1

1/4" Line Output x 2 (L/Mono & R)

Din 5pin MIDI Jack x 2 (In & Out)

### WIRELESS CONNECTIVITY

Bluetooth 5.0

### USB AUDIO

USB Interface for Recording, compatible with MacOS and Windows

2 In x 2 Out

24 Bit, 48 kHz Sample Rate

# Product Specification

## PHYSICAL UNIT

---

### DIMENSIONS

Spark LIVE:

L 464 x W 250.6 x H 306 mm  
(L 18.26 x W 9.86 x H 12.04 inch)

Spark Battery (sold separately):

L 86 x W 74 x H 48.7 mm  
(L3.38 x W2.91 x H1.91 inch)

### WEIGHT

Spark LIVE:

12 kg / 26.45 lb

Spark Battery (sold separately):

480g / 1.05 lb

### GRILLE CLOTH

Custom Black/Brown

## SOFTWARE

---

### MOBILE APPS

Spark App for iOS and Android (included)

Spark App Core Features

Smart Jam - 4 Drummers Included

Auto Chords

50,000+ Tones On ToneCloud®

Video Recording

Tuner

Mixer View (Spark LIVE exclusive)

# Front Panel

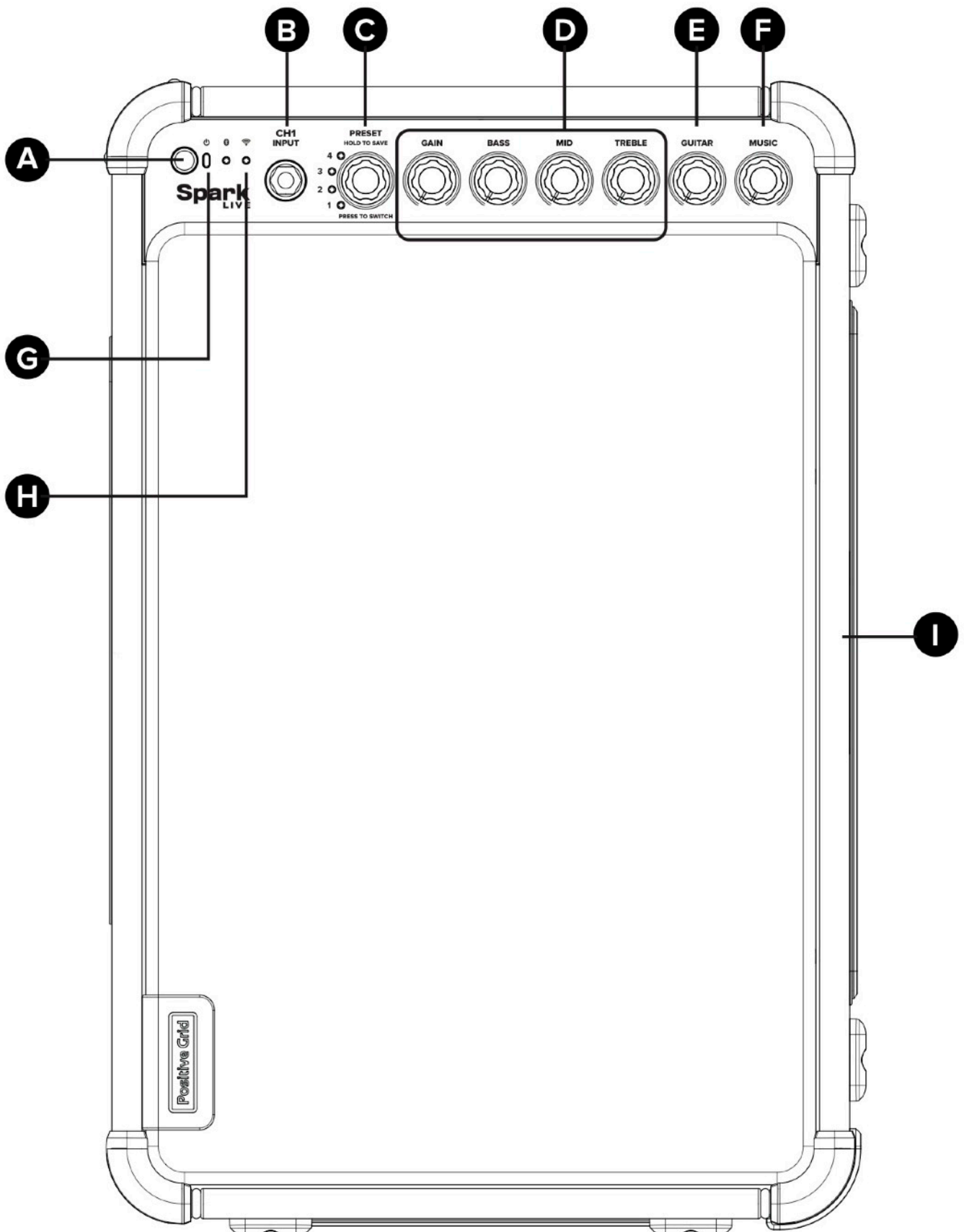

## Front Panel

### A - Power Switch

Hold to turn on/o Spark LIVE.

### B - Input Channel 1 (1/4")

CH1 supports 3 modes:

- Standard Instrument Mode (Factory Default)  
For general electric guitars, acoustic guitars, or basses
- Hi-Z Instrument Mode  
For electric guitars or basses that have high gain/output pickups or a built-in preamp
- Line In Mode  
For instruments with an output line level signal, such as keyboards, DI boxes or a line output from an external effects unit

### C - Preset Selector for Channel 1

Customize up to 8 presets for CH1. Use the knob to switch between presets, and press the knob to choose between the 4 red and 4 green presets.

### D - Amp Control

Controls the gain and EQ of the amp model in the current preset.

### E - Channel 1 Volume Control

Controls the overall volume of CH1.

### F - Music Volume Control

Controls the volume of Bluetooth music playback and USB audio.

### G - Power Indicator

Indicates power and battery status.

Without Battery Loaded:

- Solid Red: Powered on

With Battery Loaded:

- Solid Green: Powered on / Battery 50-100%
- Solid Yellow: Powered on / Battery 10-50%
- Solid Orange: Powered on / Battery under 10%
- Flashing Green/Yellow/Orange: Charging

### H - Wireless Indicators

Indicates the status of the Bluetooth and Wi-Fi connection.

- Solid Blue/Green: Connected
- Flashing Blue/Green: Pairing

### I - Speaker Stand Mount

Spark LIVE can be mounted on any 35mm standard speaker stand.

# Rear Panel

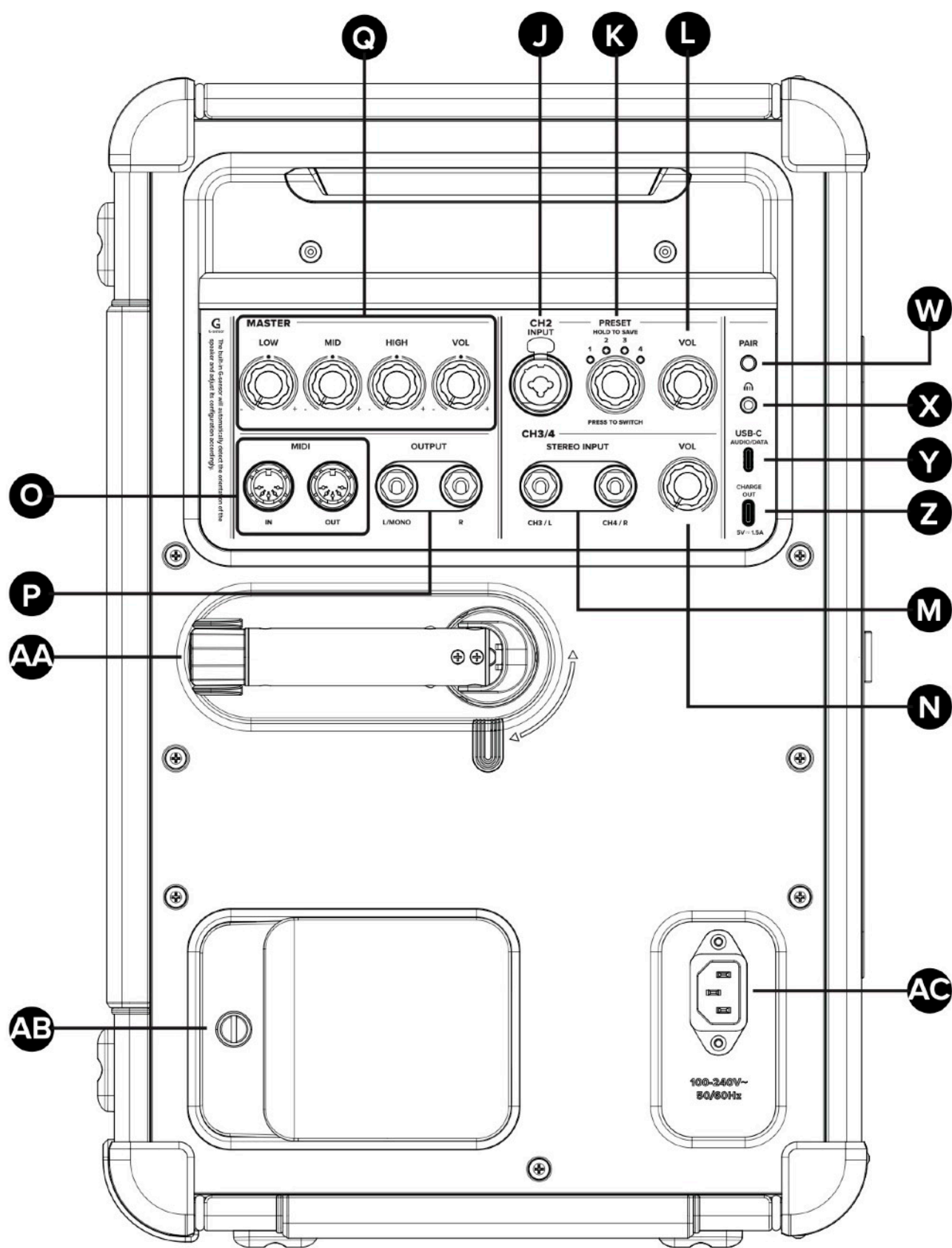

## Rear Panel

### **J - Input Channel 2 (XLR / 1/4" Combo)**

CH2 features a combo socket that supports both standard XLR or 1/4" TS line inputs. Each port supports multiple modes:

#### XLR

- Microphone Mode (Factory Default)

For standard dynamic microphones

- Line In Mode

For instruments with an output line level signal, such as keyboards, DI boxes or a line output from an external effects unit

#### 1/4" TS

- Standard Instrument Mode (Factory Default)

For general electric guitars, acoustic guitars, or basses

- Hi-Z Instrument Mode

For electric guitars or basses that have high gain/output pickups or a built-in preamp

- Line In Mode

For instruments with an output line level signal, such as keyboards, DI boxes or a line output from an external effects unit

### **K - Preset Selector for Channel 2**

Customize up to 8 presets for CH2. Use the knob to switch between presets, and press the knob to choose between the 4 red and 4 green presets.

### **L - Channel 2 Volume Control**

Controls the overall volume of CH2.

### **M - Input Channel 3/4 (1/4")**

CH3/4 has 1 pair of 1/4" sockets. You can connect either a stereo output or 2 mono outputs. Please note that the CH3/4 does not support built-in effects.

CH3/4 support multiple modes :

- Standard Instrument Mode (Factory Default)

For general electric guitars, acoustic guitars, or basses.

- Hi-Z Instrument Mode

For electric guitars or basses that have high gain/output pickups or a built-in preamp.

- Line In Mode

For instruments with an output line level signal, such as keyboards, DI boxes or a line output from an external effects unit.

### **N - Channel 3/4 Volume Control**

Controls the overall volume of CH3/4. Please note that this knob controls the volume of both channels simultaneously and cannot be adjusted separately.

### **O - MIDI Ports (Standard 5 Pin DIN)**

Input - Connect a wired MIDI controller to control built-in effects and other features.

Output - Connect to another Spark LIVE to sync them.

### **P - Line Output (1/4")**

Connect to the input of an external device, such as a PA system, audio interface, etc.

If you only need 1 output, please use the L/Mono output.

## Rear Panel

### **Q - Master EQ/Volume**

Adjust the overall EQ and volume of Spark LIVE.

### **W - Pair Button**

Press to enter Bluetooth® pairing mode when connecting to a new device.  
Hold to enter pairing mode when connecting to Spark Control X.

### **X - Headphone Output (1/8")**

Plug in a pair of headphones with a 1/8" jack.

### **Y - USB Audio Port (USB-C®)**

Connect the supplied USB-C® to USB-A cable to a PC/Mac to use as an audio interface.

### **Z - Charge Out Port (USB-C®)**

Connect a mobile device to charge it. To preserve battery life, we recommend charging mobile devices when Spark LIVE is powered by AC.

### **AA - Tilt Stand**

Use the stand to position Spark LIVE at different angles and orientations.

### **AB - Battery Slot**

Insert the Spark Battery here (sold separately).

### **AC - Power Input (IEC)**

Connect the supplied Power Cord to a power outlet.

## To play music via Bluetooth®

---

- To pair a new device, press the Pair button on the Rear Panel of Spark LIVE, turn Bluetooth® on in the settings of your mobile device, and select "Spark LIVE Audio" from the list of scanned devices.
- Spark LIVE will automatically pair with the last device it connected to. If the last device is not available, Spark LIVE will automatically connect to a device that has been previously paired.



# Using The Tilt Stand

## Horizontal Position

---

- **Step1.** Put out the tilt stand.



- **Step2.** Gently lay Spark LIVE down to prevent any damage.

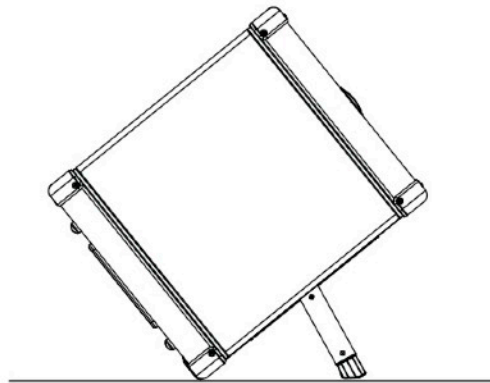

## Vertical Position

---

- **Step1.** Put out the tilt stand.

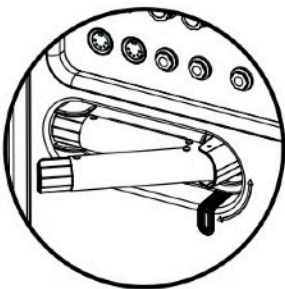

- **Step2.** Rotate 90 degrees in the direction of the arrow.

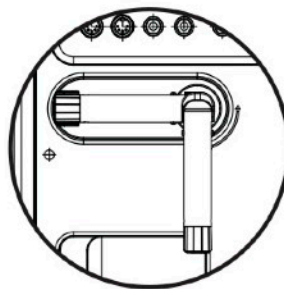

- **Step3.** Extend the stand by pressing the side buttons near the base at the same time and pulling out.

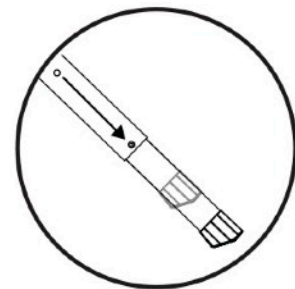

- **Step4.** For Vertical Position, the tilt stand can be adjusted to place Spark LIVE at two different angles. Simply tilt the stand either all the way up or all the way down.

- **Step5.** Gently lay Spark LIVE down to prevent any damage.

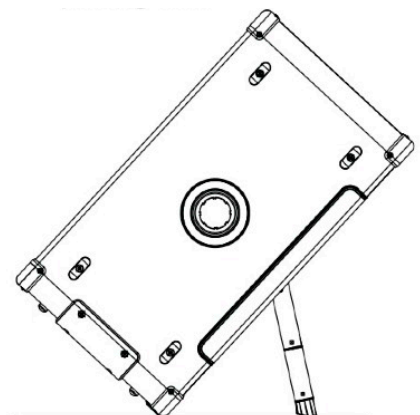
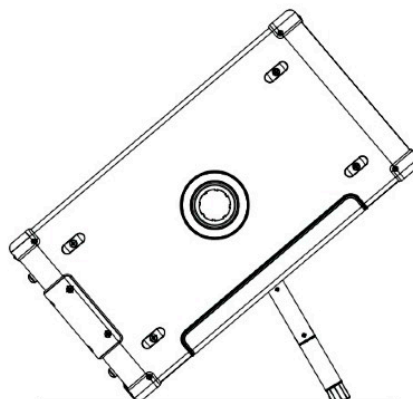

## G-Sensor

The built-in G-sensor will automatically detect the orientation of the speaker and adjust its configuration for optimum sound.

---

There are 2 modes that are dictated by the orientation of Spark LIVE:

- **Wide Mode (Stereo)**

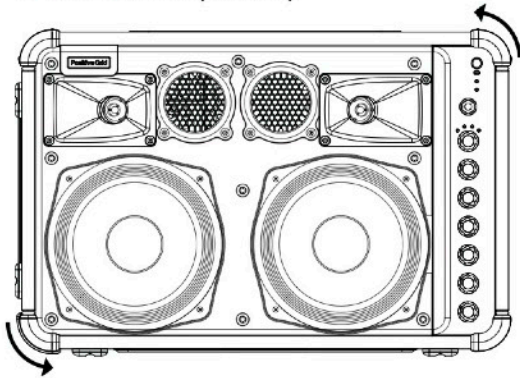

When Spark LIVE is placed horizontally, it will trigger stereo mode. This mode is recommended if panning between the left and right output channels is required.

- **Focus Mode (Mono)**

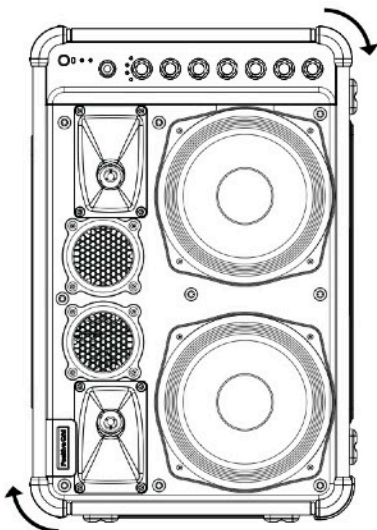

When Spark LIVE is placed vertically, it will trigger mono mode. This mode is recommended if a more focused, direct sound is required.

## Mounting Spark LIVE on a Speaker Stand

---

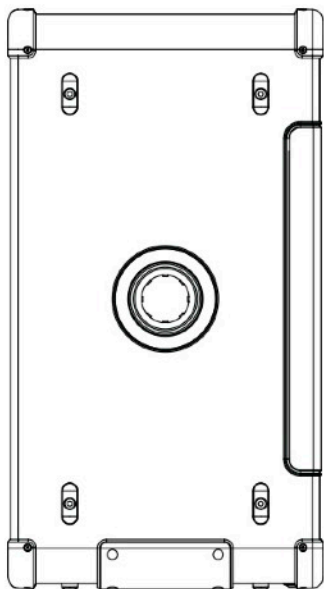

- Spark LIVE includes a port on the side for mounting on a speaker stand. It will fit any standard 35mm stand.
- Please also make sure the speaker stand can support a speaker with a minimum weight of 13kg and an overall size of 456 x 241 x 298mm.

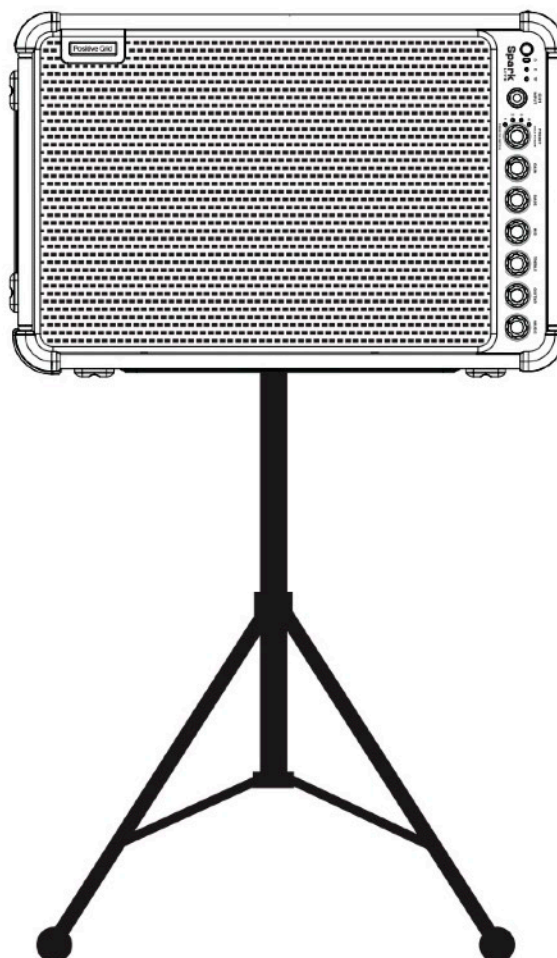

## Installing Battery

Spark LIVE is only compatible with Spark Battery (sold separately). Spark Battery has up to 8 hours of play time and automatically starts charging when Spark LIVE is plugged in via AC. Please be aware that using a third party battery can damage your Spark LIVE.

---

- Make sure Spark LIVE is off and unplug the power cord.
- Loosen the screw next to the battery cover and lift it up.
- Insert Spark Battery with the sticker facing outward.
- Put back the cover and tighten the screw.
- You can now turn on Spark LIVE using battery power.

**\*Do not remove or install Spark Battery while Spark LIVE is powered on.**

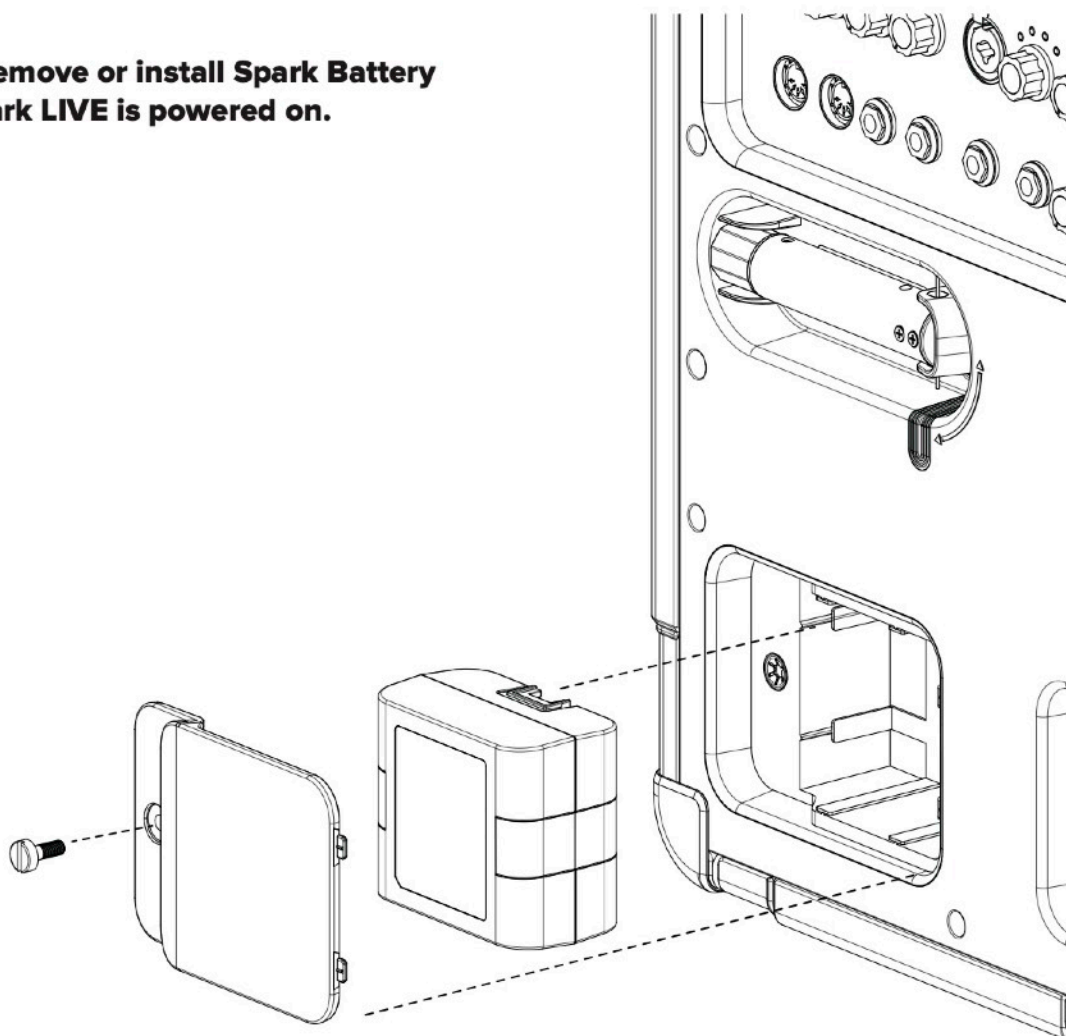

## Pairing With A Spark Control X

---

- **Step1.** Turn on the Spark LIVE and Spark Control X

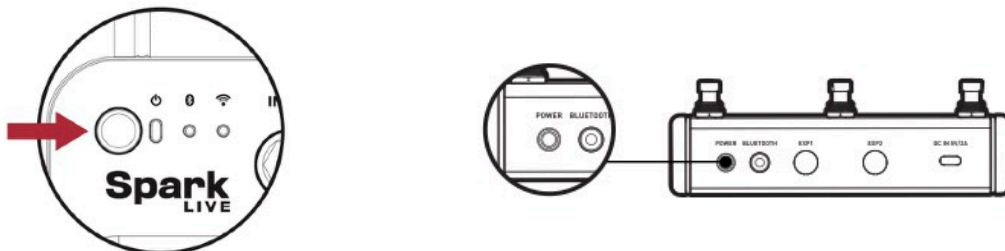

- **Step2.** Long press the Pair Button on the Rear Panel until both Wireless Indicator LEDs on the Front Panel light up.

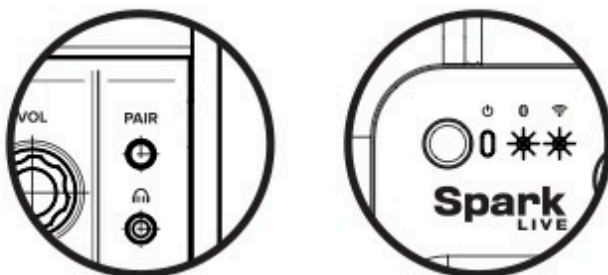

- **Step3.** Spark LIVE will automatically connect to the Spark Control X.

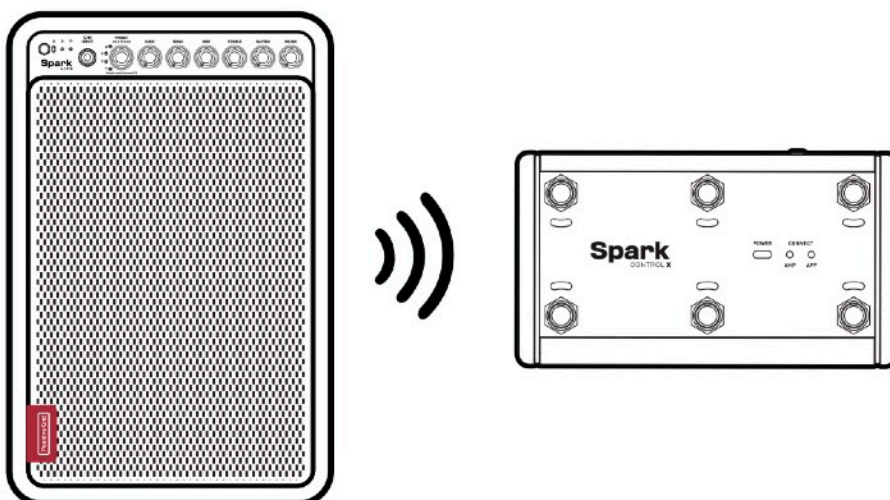

## Tuner Mode

- Double tap the Preset Knob of CH1 to enter tuner mode.
- While in tuner mode, the 4 Preset LEDs will display if the string being played is in tune.
- Note that the output of Spark LIVE will be muted while tuner mode is on.
- To exit tuner mode, press the Preset Knob again.

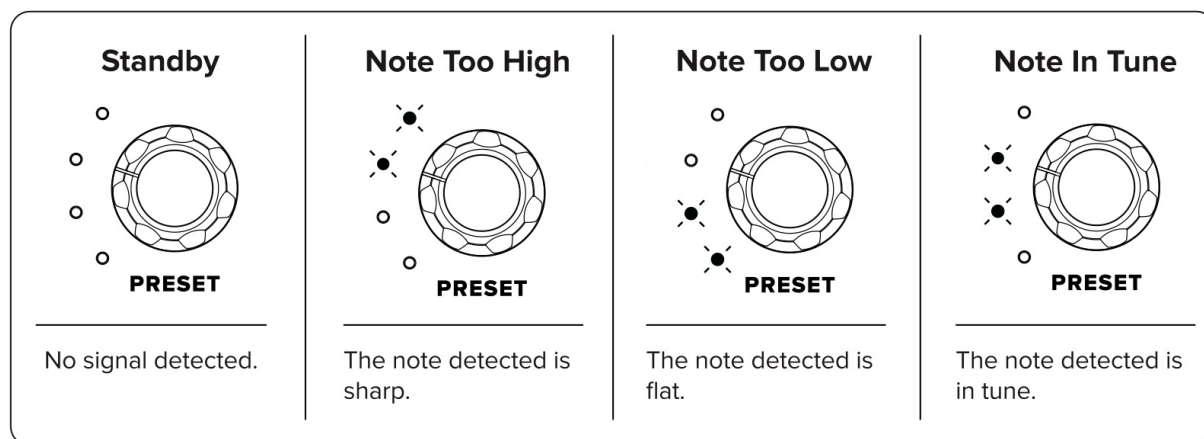
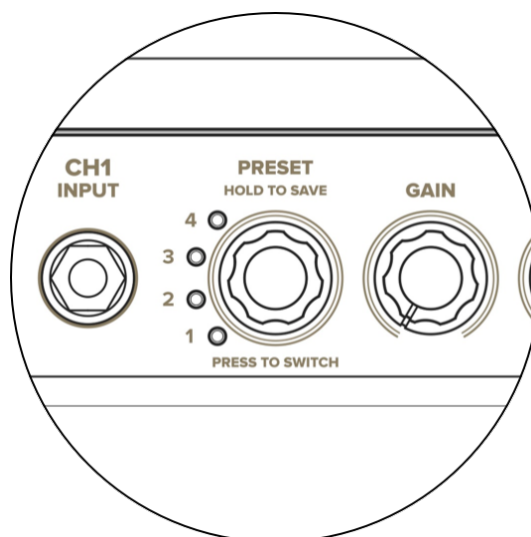

# Factory Default Settings

## Default Built-in Presets

### CH1

- Red Preset 1 : Rhythm Guitar Style Tone 1
- Red Preset 2 : Lead Guitar Style Tone 1
- Red Preset 3 : Solo Guitar Style Tone 1
- Red Preset 4 : Ambient Guitar Style Tone 1
- Green Preset 1 : Rhythm Guitar Style Tone 2
- Green Preset 2 : Lead Guitar Style Tone 2
- Green Preset 3 : Solo Guitar Style Tone 2
- Green Preset 4 : Ambient Guitar Style Tone 2

### CH2

- Red Preset 1 : Vocal - Lead
- Red Preset 2 : Vocal - Studio Echo
- Red Preset 3 : Vocal - Chorus
- Red Preset 4 : Vocal - Lofi
- Green Preset 1 : Acoustic Guitar - Modern Crisp Tone
- Green Preset 2 : Acoustic Guitar - Warm Woody Tone
- Green Preset 3 : Bass - Clean and Bright
- Green Preset 4 : Bass - Overdriven Bass

More presets can be downloaded and customized for free on ToneCloud. You can access ToneCloud via the Spark app, search for a custom preset, download it for free, and then save the preset directly to Spark LIVE by tapping 'Save to hardware preset' in the menu.

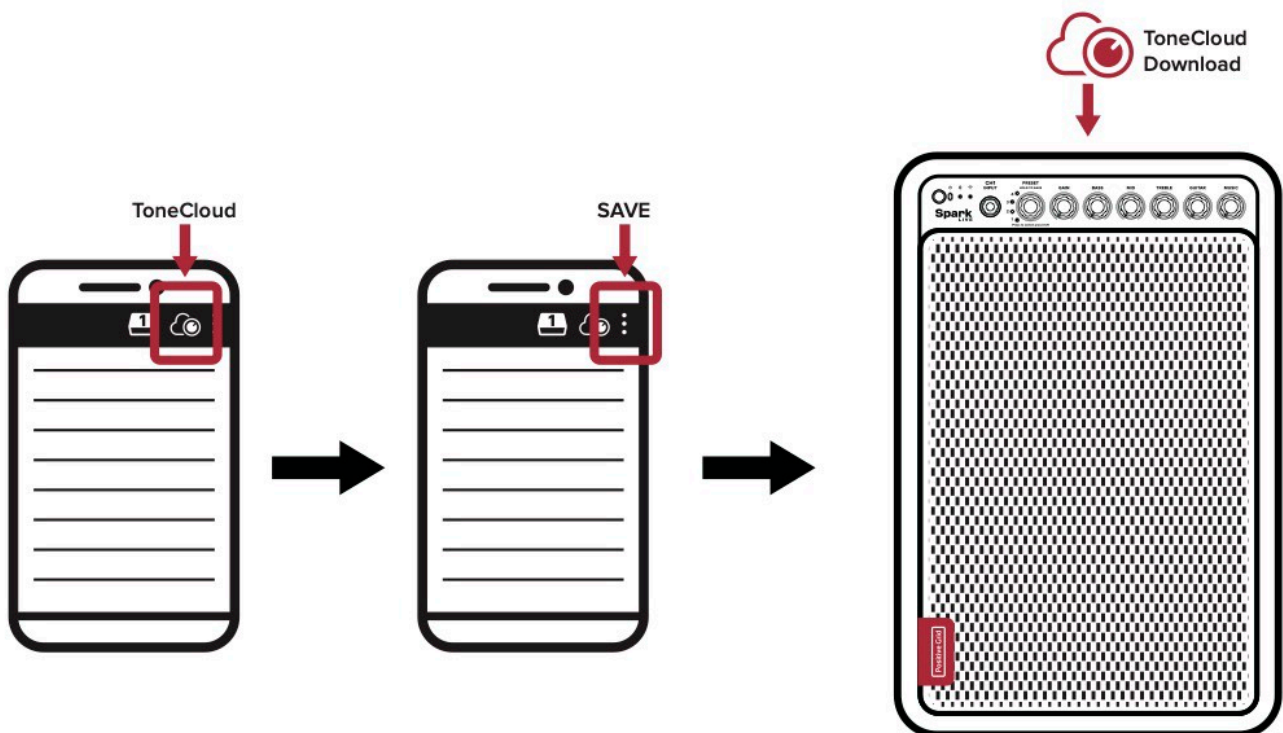

## MIDI In Settings

Function	Message Type	Message Number	MIDI Channel
<CH1> Switch To Red Preset 1	Program Change	0	1
<CH1> Switch To Red Preset 2	Program Change	1	1
<CH1> Switch To Red Preset 3	Program Change	2	1
<CH1> Switch To Red Preset 4	Program Change	3	1
<CH1> Switch To Green Preset 1	Program Change	4	1
<CH1> Switch To Green Preset 2	Program Change	5	1
<CH1> Switch To Green Preset 3	Program Change	6	1
<CH1> Switch To Green Preset 4	Program Change	7	1
<CH2> Switch To Red Preset 1	Program Change	8	1
<CH2> Switch To Red Preset 2	Program Change	9	1
<CH2> Switch To Red Preset 3	Program Change	10	1
<CH2> Switch To Red Preset 4	Program Change	11	1
<CH2> Switch To Green Preset 1	Program Change	12	1
<CH2> Switch To Green Preset 2	Program Change	13	1
<CH2> Switch To Green Preset 3	Program Change	14	1
<CH2> Switch To Green Preset 4	Program Change	15	1
<CH1> Toggle Effect Slot 1	Control Change	0	1
<CH1> Toggle Effect Slot 2	Control Change	1	1
<CH1> Toggle Effect Slot 3	Control Change	2	1
<CH1> Toggle Amp Slot	Control Change	3	1
<CH1> Toggle Effect Slot 4	Control Change	4	1
<CH1> Toggle Effect Slot 5	Control Change	5	1
<CH1> Toggle Effect Slot 6	Control Change	6	1
<CH2> Toggle Effect Slot 1	Control Change	30	1
<CH2> Toggle Amp Slot	Control Change	30	1
<CH2> Toggle Effect Slot 2	Control Change	30	1
<CH2> Toggle Effect Slot 3	Control Change	30	1
<CH2> Toggle Effect Slot 4	Control Change	30	1
<CH1> Channel Volume	Control Change	20	1
<CH2> Channel Volume	Control Change	21	1
<CH3> Channel Volume	Control Change	22	1
Master Volume	Control Change	23	1
<CH1> Toggle Tuner	Control Change	7	1
Tap Tempo	Control Change	8	1

## Factory Reset

---

Follow the steps below to perform a factory reset. This process will reset all the presets stored on the Spark LIVE as well as its Bluetooth pairing information, Power Saving Setting.

1. Turn off your Spark LIVE.
2. Hold the Power Button and Preset Knob, then release the buttons when the Power Indicator turns into white color.
3. Hold the Power Button, until all four preset LEDs blink, then release the button.
4. Spark LIVE will be turned off automatically when the factory reset is completed, turn it back on to start playing.

\*After the step 2, if you're not ready to perform factory reset, or tends to do it later, you can cancel the process by tapping the Power Button.

## Force Shutdown & Restart

---

If Spark LIVE runs into an issue where the knobs/buttons doesn't respond anymore or freezes, or emits an unusual noise, follow the steps below to force shutdown and restart Spark LIVE.



1. Hold the Power button over 10 seconds.
2. Release the Power button, and hold it again to turn Spark LIVE on.

**Spark App**

# **User Guide**



## DOWNLOAD YOUR SPARK APP



**App Store**  
Supported iOS 12 or later



**Google Play**  
Supported Android 8 or later

Download and install the Spark App compatible with your smartphone's operating system.

## Connecting Spark Amp to Your Smartphone

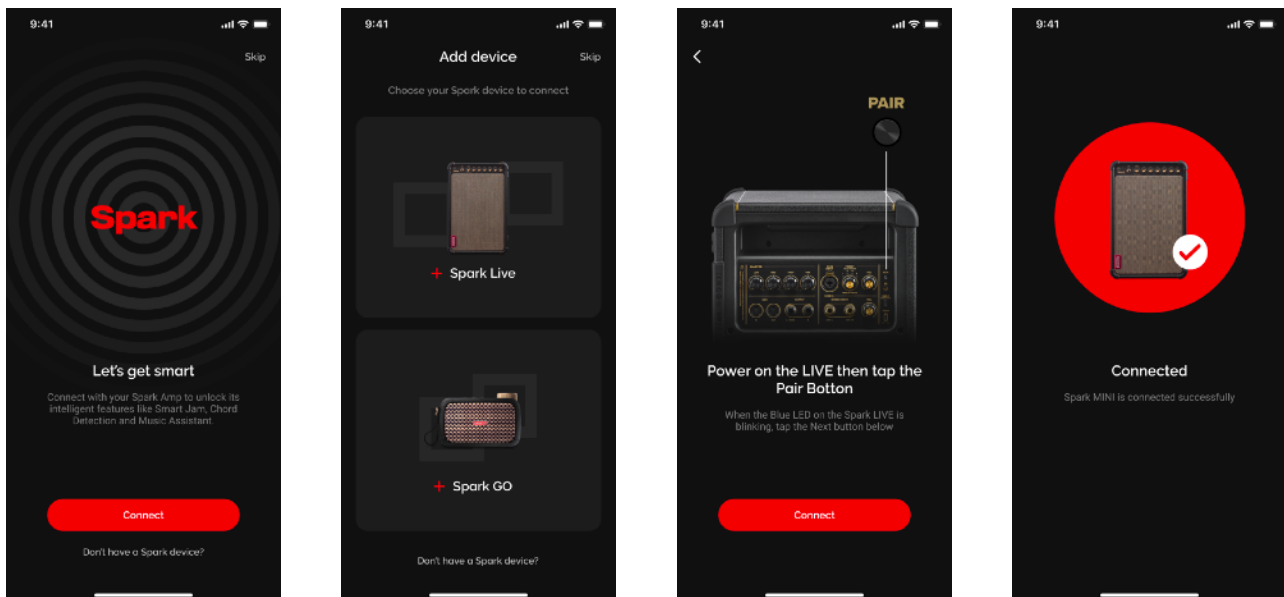

- (A) Make sure to allow the Spark app access to Bluetooth (iOS) or Location Services (Android) to allow the Spark app to establish a Bluetooth connection with your Spark LIVE.
- (B) Turn on Bluetooth on your smartphone and Spark device.
- (C) Select the device you want to connect to.
- (D) Enter Pairing Mode by pressing the Pair button on the Spark LIVE, then tap the connect button in the app.

Tip: Connect Spark Amp to your smartphone as a Bluetooth speaker to play music. A stable connection between the amp and the app is required for audio output.

Tip: Selecting a device will only occur when you first install the Spark app. Subsequent connections will be done by pressing the connect button when you enter the Spark app.

Tip: If you are unable to connect to the amp, ensure that other nearby Bluetooth devices are turned off and try again.

## Log In to Your Positive Grid Account

Log in to your Positive Grid account to download tones from the ToneCloud and more.

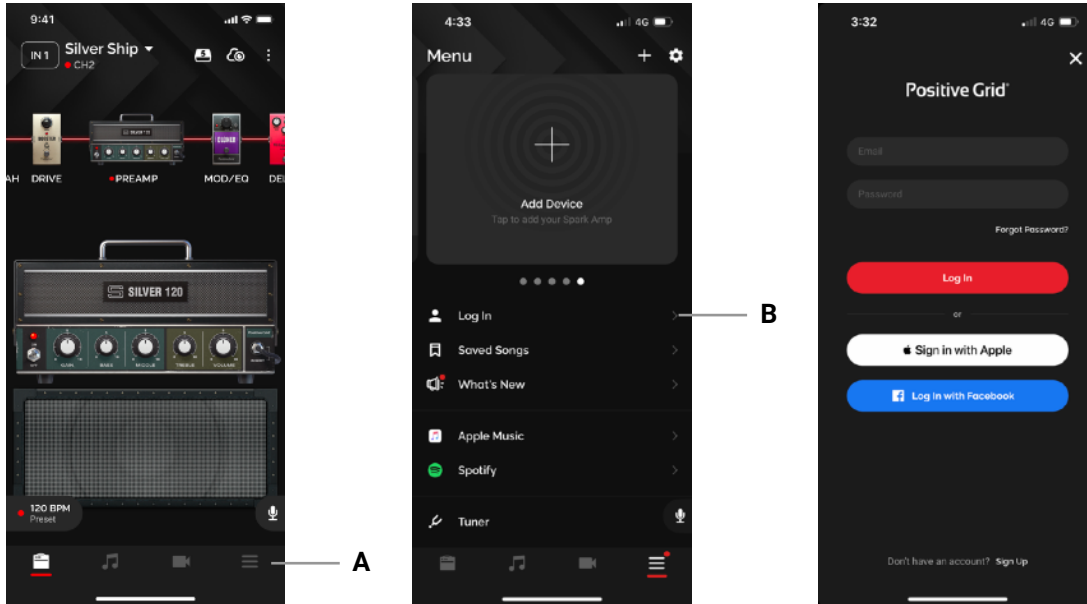

(A) Tap the Menu icon



(B) Tap Log In

(C) Log in with your existing account, use your Apple ID or Facebook ID, or tap on Sign Up to create a new account

## Manage Your Profile

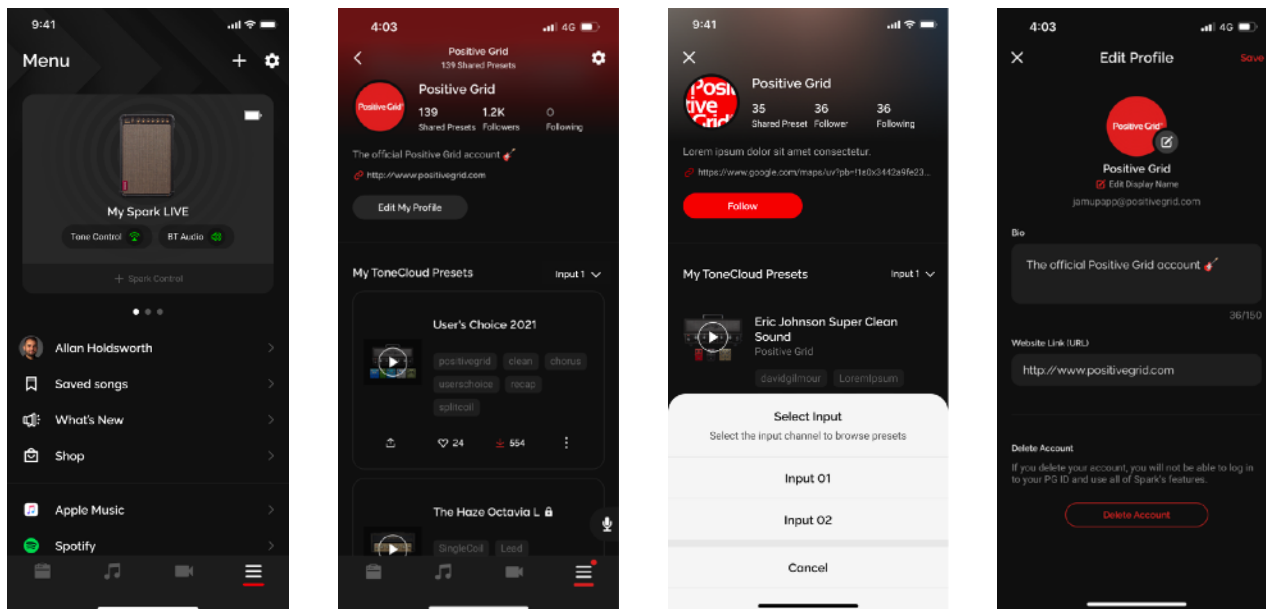
Set up your profile to manage your ToneCloud presets and connect with other Spark users.



- (A) Once you log in, a Set Up Your Profile prompt should appear, which will take you to the Edit Profile Page. You may edit your profile after the fact by going into your profile via the Menu page and tapping on your profile, then tapping on Edit My Profile.
- (B) You may edit your Display Name, which is the name that will be shown to others in the ToneCloud, edit your Bio and your URL, and delete your account.
- (C) You may edit your ToneCloud preset details by tapping on the  icon to rename or delete the preset from the ToneCloud.
- (D) You may also log out by tapping the  icon
- (E) Tap on the Input Selector to see your presets for different inputs.

Note: Deleting your account is permanent and you will not be able to log in with your previously deleted account credentials.

## Adjusting Effects and Presets

After connecting your Spark amp to the Spark app, you may tweak settings to your liking or browse our factory presets.

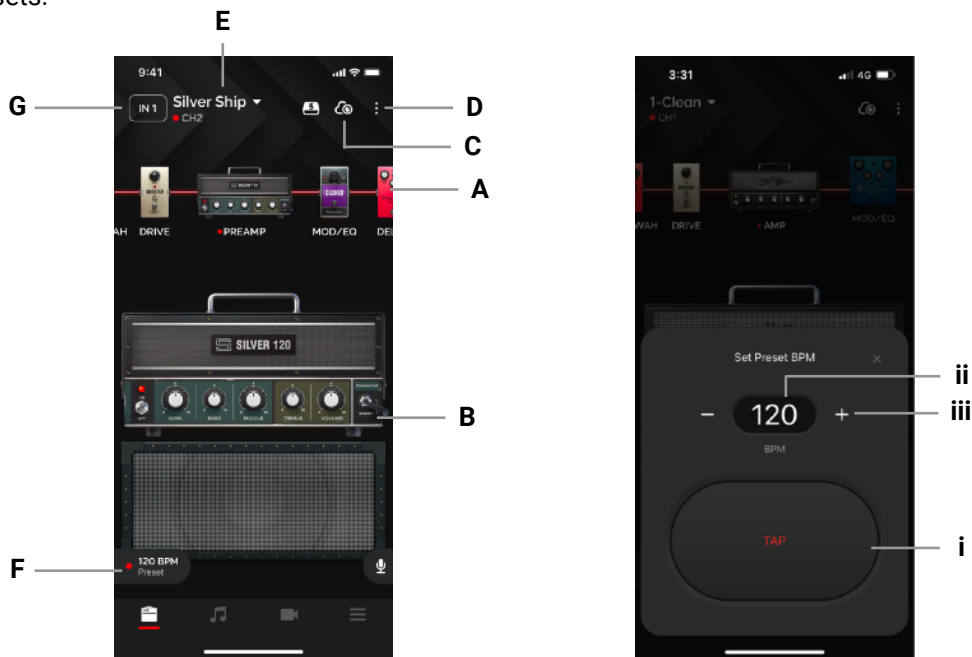

### (A) Signal Chain:

1. Swipe left or right to scroll along the signal chain (For mobile)
2. Swipe up and down to switch effects on and off.
3. Double-tap the amp or effects icon to select an effect.

### (B) Effects Section:

1. Effects on/off: tap the LED on the amp/effect pedal to switch the effect on and off.
2. Tone control: turn the knobs to adjust the parameters

### (C) ToneCloud: tap the top right icon to open ToneCloud.

### (D) Option Menu:

1. Overwrite - overwrite the current preset.
2. Save as New - save as a new preset.
3. Share to ToneCloud - share your current preset to ToneCloud.
4. Save to Hardware - save your current preset to a Spark LIVE Amp preset slot.

(E) Local Presets - tap the preset name to select presets you've saved to your smartphone  
The red dot along with CH1/2/3/4 or RHYTHM/LEAD/SOLO/CUSTOM underneath the Preset name indicates that a preset saved on the Spark amp itself is currently being used.

(F) Tap Tempo - sync up delays and modulations when the BPM sync toggle on the effect is on by assigning a BPM to your preset. You may adjust BPM in 3 ways:

- (i) Tap the TAP button to tap a tempo
- (ii) Tap the BPM value and type in your desired BPM
- (iii) Tap the + or - buttons to adjust by 1 BPM, long press the buttons to jump up by increments of 10 BPM

(G) Input Selector - Shift between Input 1 and 2 on the Spark LIVE. The ToneCloud and Local Presets menu will only show presets compatible with that input (e.g. When tapping into the ToneCloud while in Input 1, only presets compatible with Input 1 will show, and vice versa)

## Mixer View (Spark LIVE Only)

After connecting your Spark amp to the Spark app, you may tweak settings to your liking or browse our factory presets.

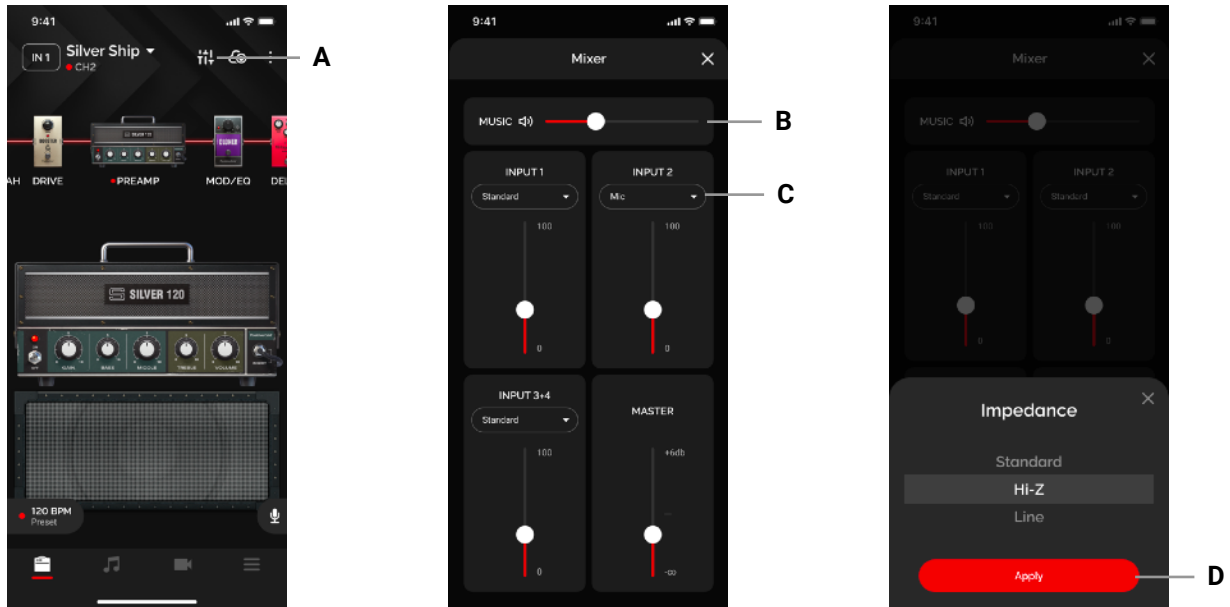

(A) Mixer View - Tap into the Mixer View Icon to go into Mixer View

(B) Adjust Volume for Music, Inputs 1, 2 and 3+4, as well as Master Volume.

(C) Tap on the impedance drop down menu to adjust the impedance of the inputs.

(D) Once the desired impedance is selected, tap on Apply to apply the setting to that input.

## Exploring the ToneCloud®

The ToneCloud® is a preset sharing system developed by Positive Grid. Sync your presets across devices, take your tones on the road, share your presets or download presets designed by other musicians in our community from all over the world!

### Search and Preset Actions

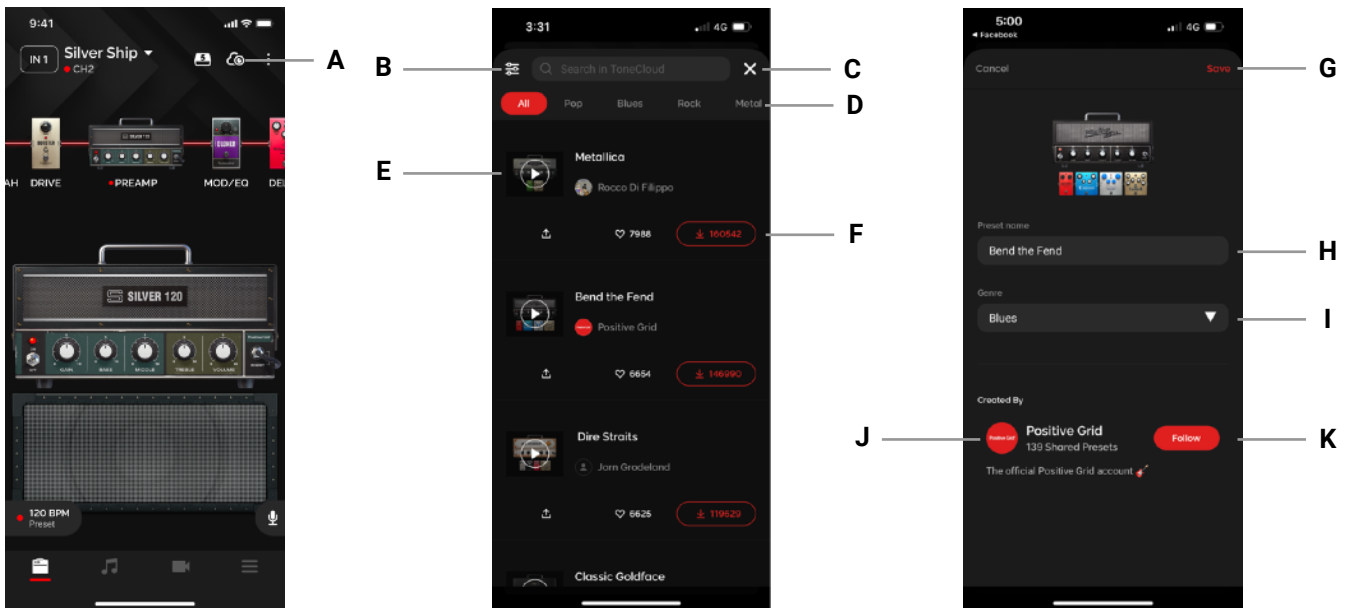



- (A) Tap on the ToneCloud icon to access the ToneCloud for the current input
- (B) Tap to Sort presets
- (C) Tap the X to exit the ToneCloud
- (D) Tap on the categories to browse presets by genre
- (E) Tap the Play button on the Preset thumbnail to preview a tone when connected to the Spark amp
- (F) From Left to Right; (i) [ToneLink] Tap on the Share button to share a link to the preset externally, (ii) Tap on the Like button to add the preset to your favorites, (iii) Tap the Download button to bring up the Download menu
- (G) Tap Save to save the preset to your local preset list
- (H) Rename the preset before you save
- (I) Select which category you would like the preset to show up in
- (J) Tap on the Profile to explore the preset creator's profile
- (K) Tap on Follow to follow the creator, their presets will show up in the Following category in the ToneCloud

Quick Tip: The ToneCloud only shows presets that are compatible with the current input you're exploring!

## Share Your Own Presets to the ToneCloud

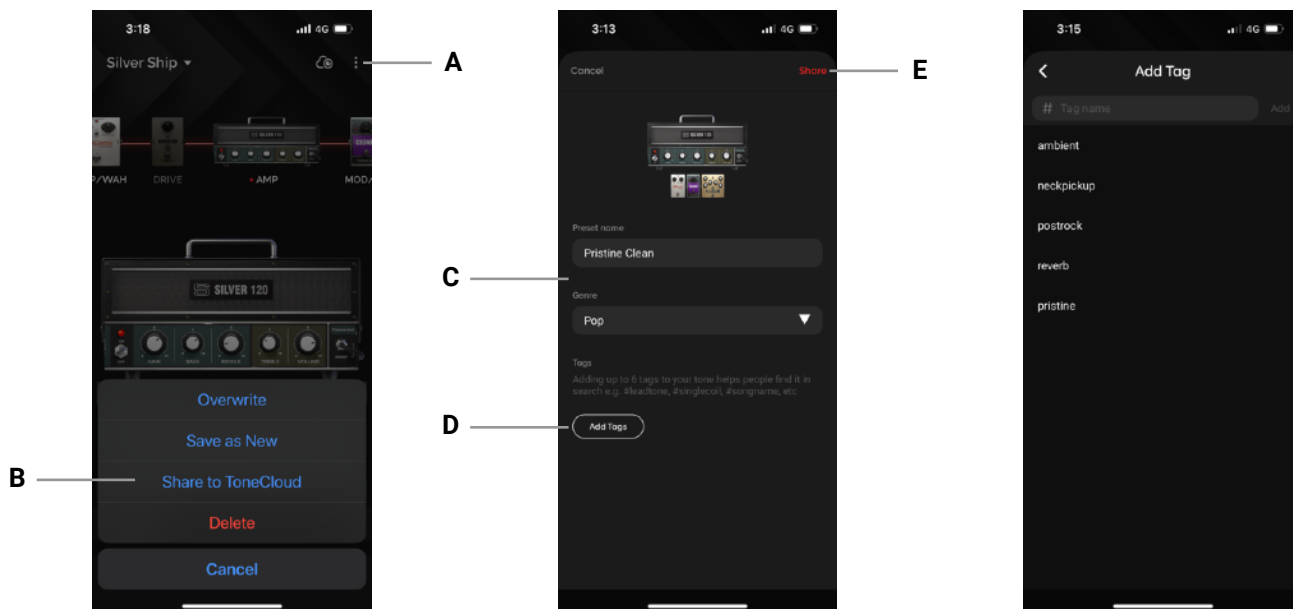
Share presets you've designed yourself for others in the Spark community to enjoy.



(A) Tap on the  on the top right of the Tone page

(B) Tap Share to ToneCloud

(C) Rename the Preset and select a genre

(D) Add up to 6 tags to make it easier for others to search for your preset; some suggested tags would be pickups used (single coil, humbucker, etc), which pickup position was used, characteristic of the tone (ambient, crunchy, highgain, etc) and its usage (lead, rhythm, solo, etc), artist or song, etc.

(E) Tap Share to share it to the ToneCloud

## Explore Other's Profiles

Get to know other musicians in the Spark community by exploring and following their profile.

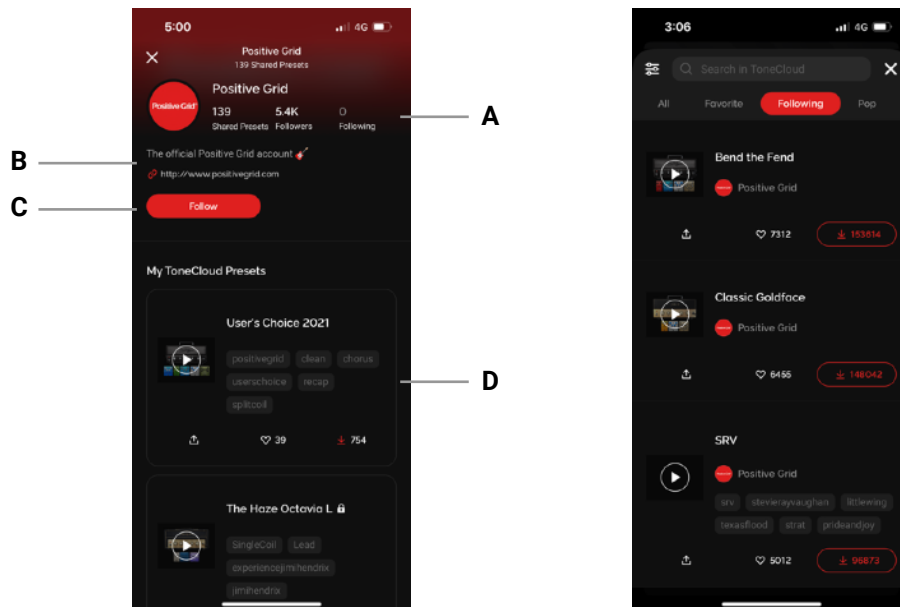

- (A) Tap on Followers or Following to see who the profile owner is following or being followed by.
- (B) Read the profile's Bio or tap on their link to learn more about them.
- (C) Tap on Follow to add them to your follow list; their presets will show up in the Following category of the ToneCloud.
- (D) Explore presets that have been shared to the ToneCloud by the profile owner.

## Using Smart Jam

Spark Amp and app work together as one unit to learn your style and feel, then generates authentic drums and bass tracks to accompany you.

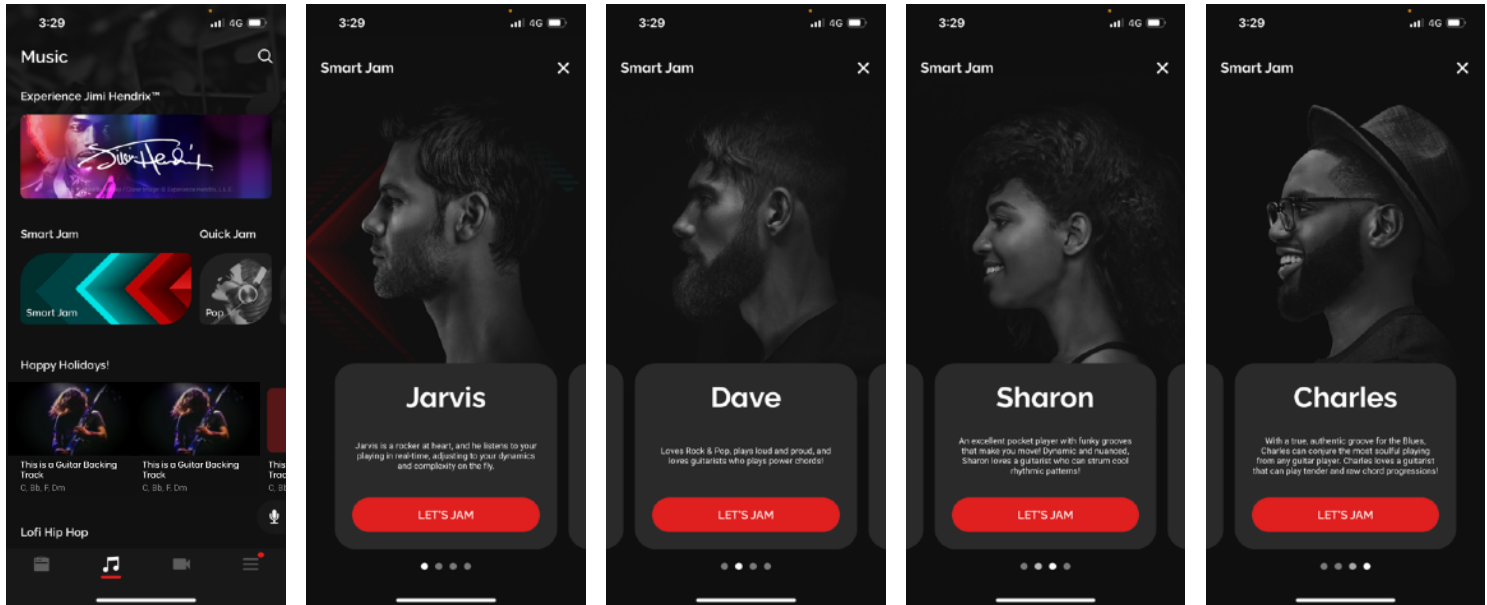

Make sure you are connected to your Spark device's Bluetooth Audio, then tap on the Music page and tap on the Smart Jam banner. Select 1 of the 4 drummers available by swiping left or right to begin.

### - Jarvis

Jarvis is a rock-style drummer who will listen to your dynamics and feel while you're playing, and provide you with real-time feedback with louder or softer hits, and more simple or complex grooves. [More on that later.](#)

### - Dave

Dave is a Rock style drummer who hits hard and hits loud! Dave will listen to your chords and create a backing track that follows a song structure, with a Verse, followed by a Chorus, then a Bridge, and another Chorus, according to what you played.

### - Sharon

Sharon is a Funk style drummer with grooves that make you move! Sharon will also listen to your chords and create a backing track that will follow a song structure according to your initial chord progression and strumming pattern.

### - Charles

Charles is a Blues style drummer who plays to help you bring out your most soulful playing. With Charles, you can choose between a straight and shuffle feel, and between an 8-bar or 12-bar blues progression. Once you've selected the feel and BPM, start playing your desired chord progression and let the blues take over!

## Playing With Dave/Sharon/Charles

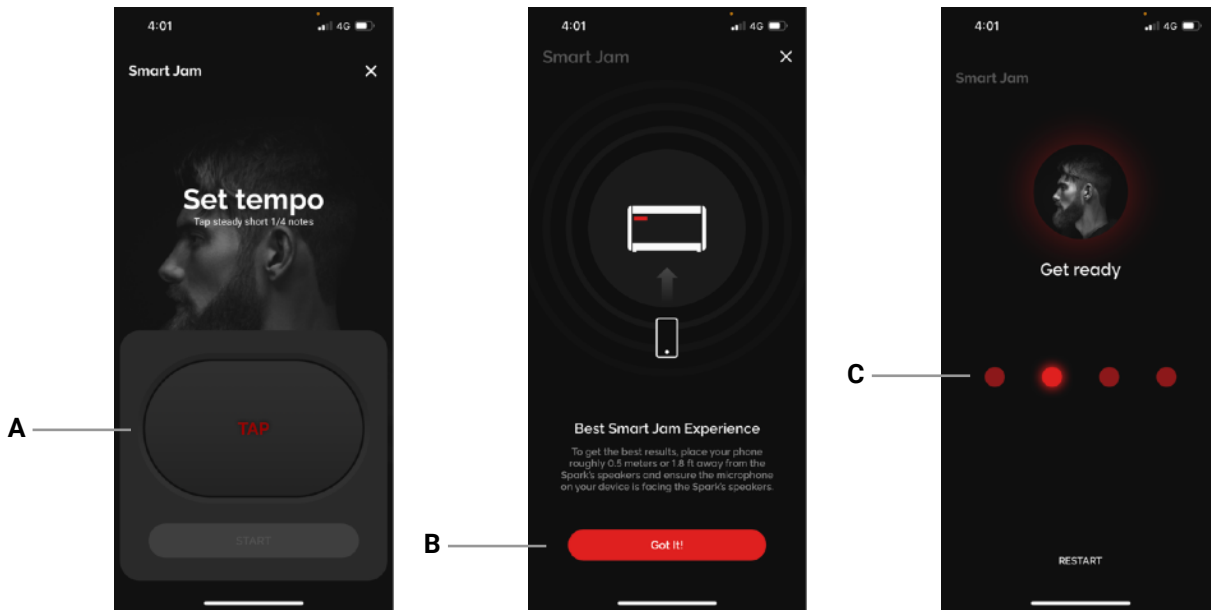

- A. Set a tempo by tapping the TAP button to tap a tempo. You may adjust in increments of 1 with the +/- sign once an initial tempo has been set, and increments of 10 by tapping and holding the buttons, then tap Start.
- B. For first time Smart Jam users, you will be reminded to place your device roughly 0.5 meters or 1.8 feet away from your Spark's speakers, with the microphone facing the Spark amp's speakers for the best results.
- C. You will be given 4 beats to count you in. If you do not hear the clicks, please ensure that your device is connected to Spark's Bluetooth audio and that your device and Spark's music volume is turned up.

- D. The drummer will listen to your playing after the 4 initial beats. All the Smart Jam drummers currently support 1 chord every 2 beats. Make sure to observe the red bar at the bottom of the screen; when the red line goes across the entire screen, it means you have clipped the microphone on your device, and the results may not be accurate.
  1. You may play up to 8 bars, but if your chord progression is only 4 bars, you may tap the checkmark button when it's highlighted on the screen to skip the last 4 bars.
  2. Once the analysis is complete, select from the 6 tracks that have been created by the drummer that you like best. Swipe left or right to scroll between each option and preview the tracks.

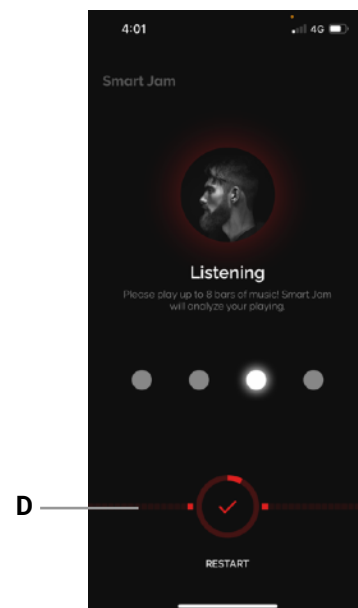

## Playing With Dave/Sharon/Charles

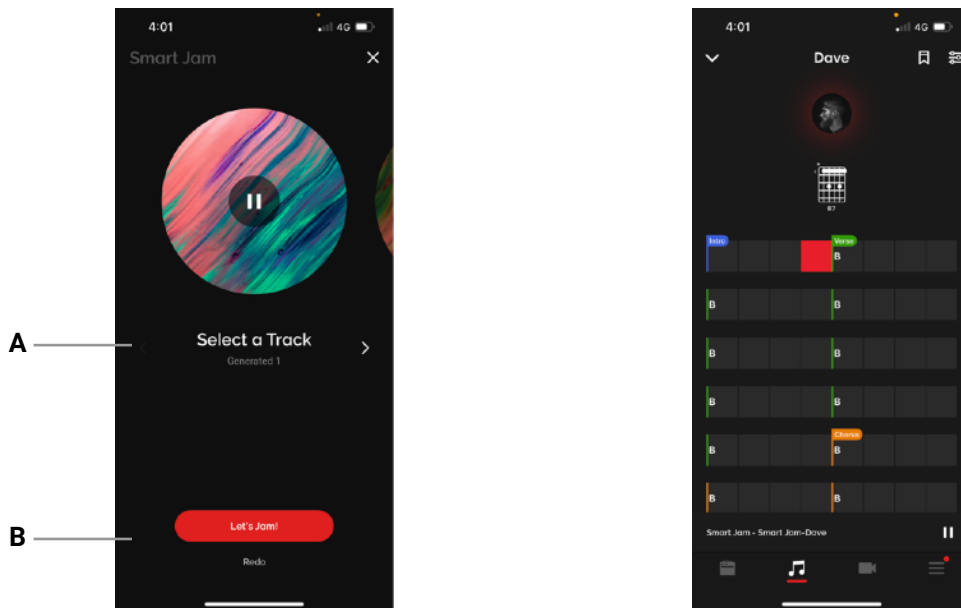

- A. Once the analysis is complete, select from the 6 tracks that have been created by the drummer that you like best. Swipe left or right or tap the arrow icon to scroll between each option and preview the tracks.
- B. After selecting a track, you will be taken to the Smart Jam detail page where you can start jamming! Tap redo if you'd like to record another chord progression.

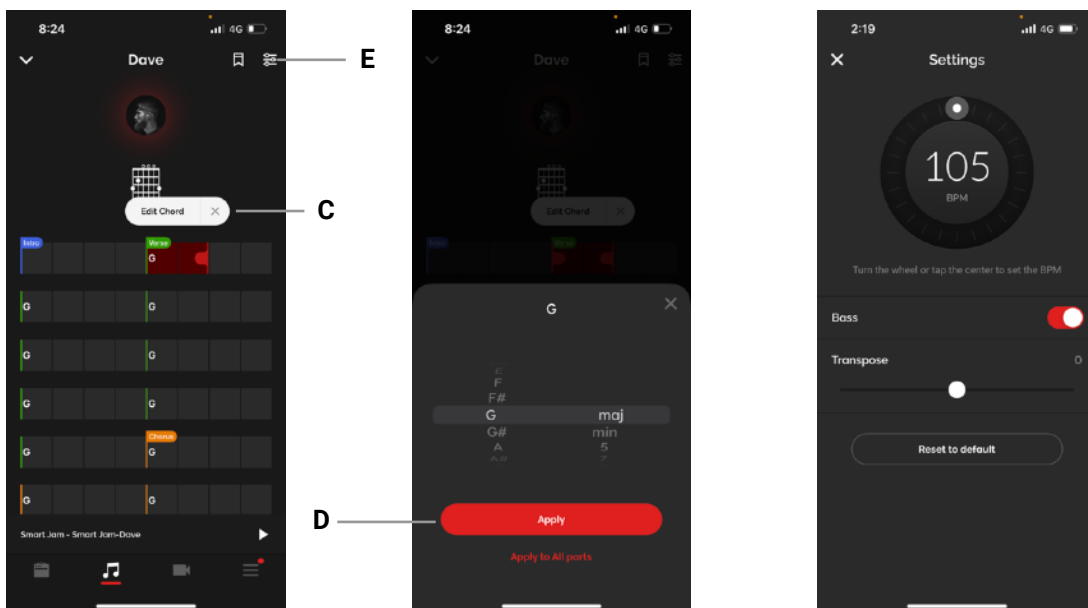

- C. You may edit the chords by pausing the track, then long pressing any of the chords then tapping Edit Chord. Select more than one bar by dragging the red indicator to the right of the selected area.
- D. After changing the chord to your desired chord, tap apply to apply the chord change just to the selected range, or tap Apply to All Parts to apply the chord change to all sections of the Smart Jam track.
- E. Tap on the Settings icon on the top right to go to the Smart Jam settings menu, where you can adjust BPM, turn off the Bass track, and transpose the track by increments of half steps to a maximum of an octave up or down. Tap Reset to default to reset to the initial analyzed or saved settings.

## Playing With Jarvis

Jarvis is unique in that they will listen to your playing in real time and change along with your dynamics and complexity of your playing while you play.

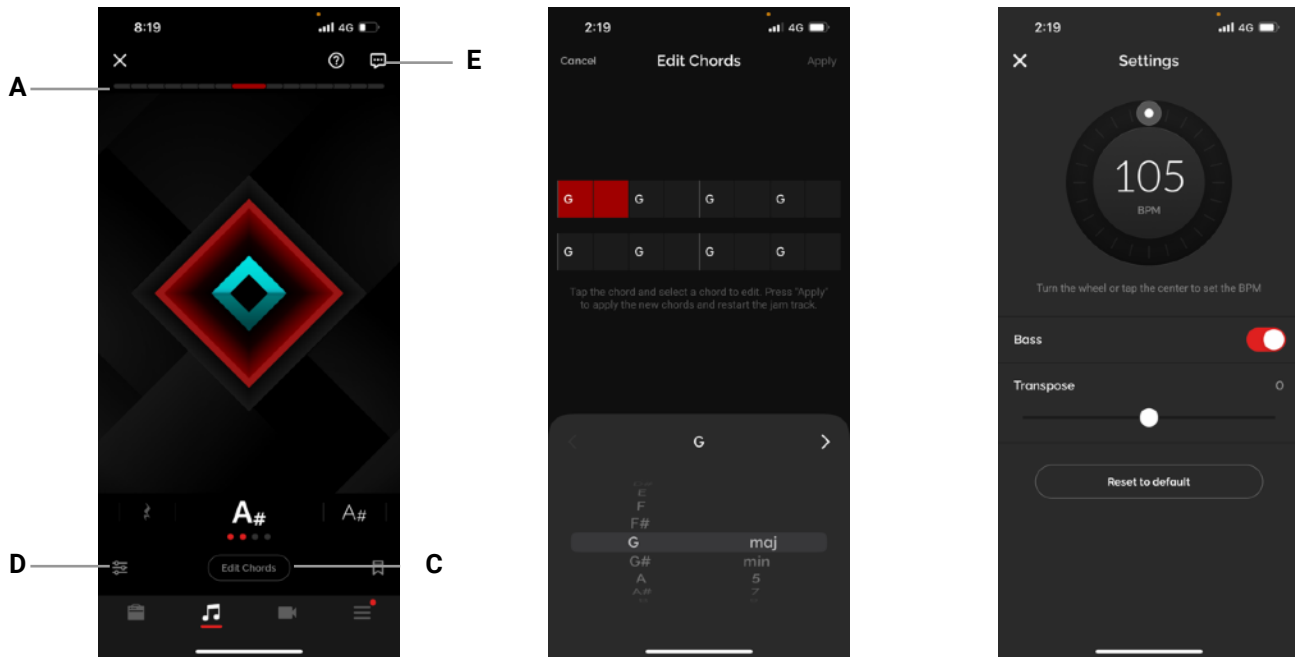

Follow the steps for playing with Dave/Sharon/Charles:

- A. For the best real time jamming experience, observe the top red bar and do the following calibration during your first playthrough with Jarvis:
  1. At your loudest playing level, ensure that the top red bar is almost at maximum. If it's at maximum, it indicates that your device's microphone is clipping; turn the volume of your instrument and music accordingly to ensure it's not clipping.
  2. At your quietest playing level, ensure that the top red bar is at roughly 3 red blocks. This minimum and maximum range will have better dynamic detection.
  3. Make sure your guitar is louder than the backing track. Try to aim for a volume balance with your guitar and backing track at roughly 2:1 or 2:1.5. This will make it easier for Jarvis to detect your guitar playing.
- B. To edit chords, tap the Edit Chords button, then select the chord you'd like to edit. Once you've changed your desired chords, tap Apply to apply the changes to the track.
- C. Tap the Settings icon on the bottom left to change the jam track's settings; you may adjust the tempo, turn off the bass, and transpose the track by increments of half steps and up to a whole octave up or down. Tap Reset to default to reset the track to the analyzed or saved version of the track.
- D. Leave feedback by tapping on the Feedback icon on the top right of the page, and to review instructions for using Jarvis, tap the Help icon next to it.

## Saving a Backing Track

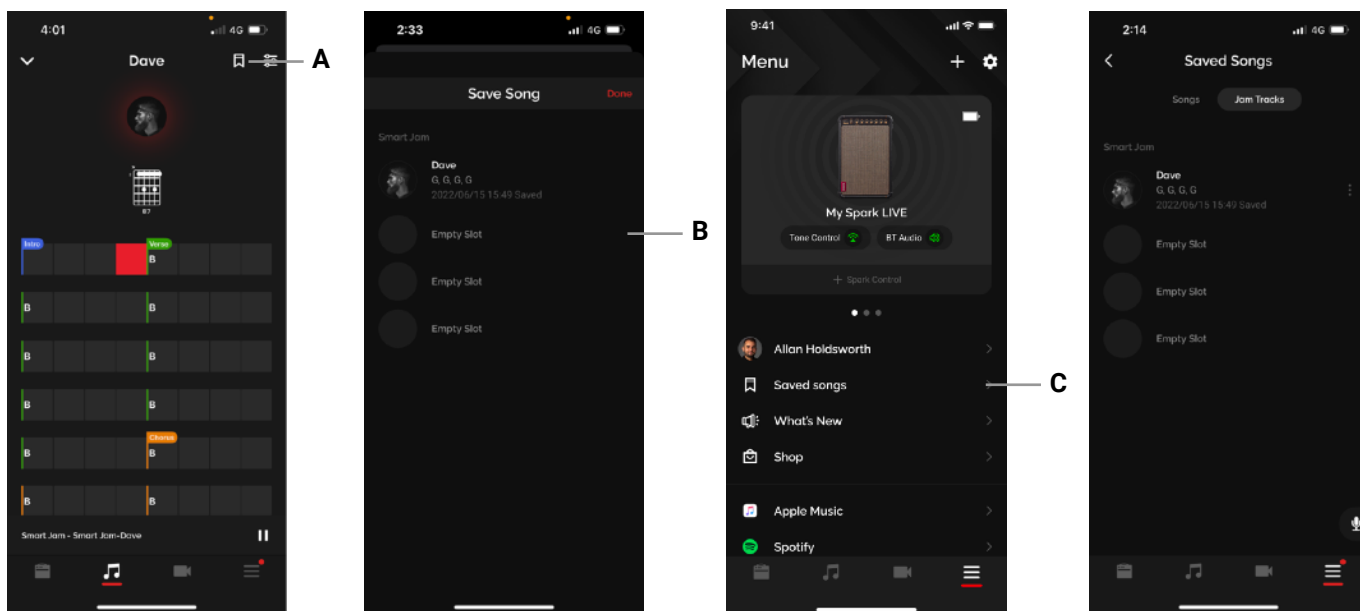

- A. You may save a backing track by tapping on the bookmark icon available in the Smart Jam detail page for all drummers.
- B. Select a save slot to save your backing track.
- C. Access your saved Smart Jam tracks from the Saved Songs page in the Menu, then select the Smart Jam tab. Tap on your desired jam track to load a previously saved Smart Jam track. You may also rename or clear the track from the slot by tapping on the  icon.

## Starting a Quick Jam

Quick Jam are backing tracks that use the same audio engine as Smart Jam with preset chord progressions and grooves.

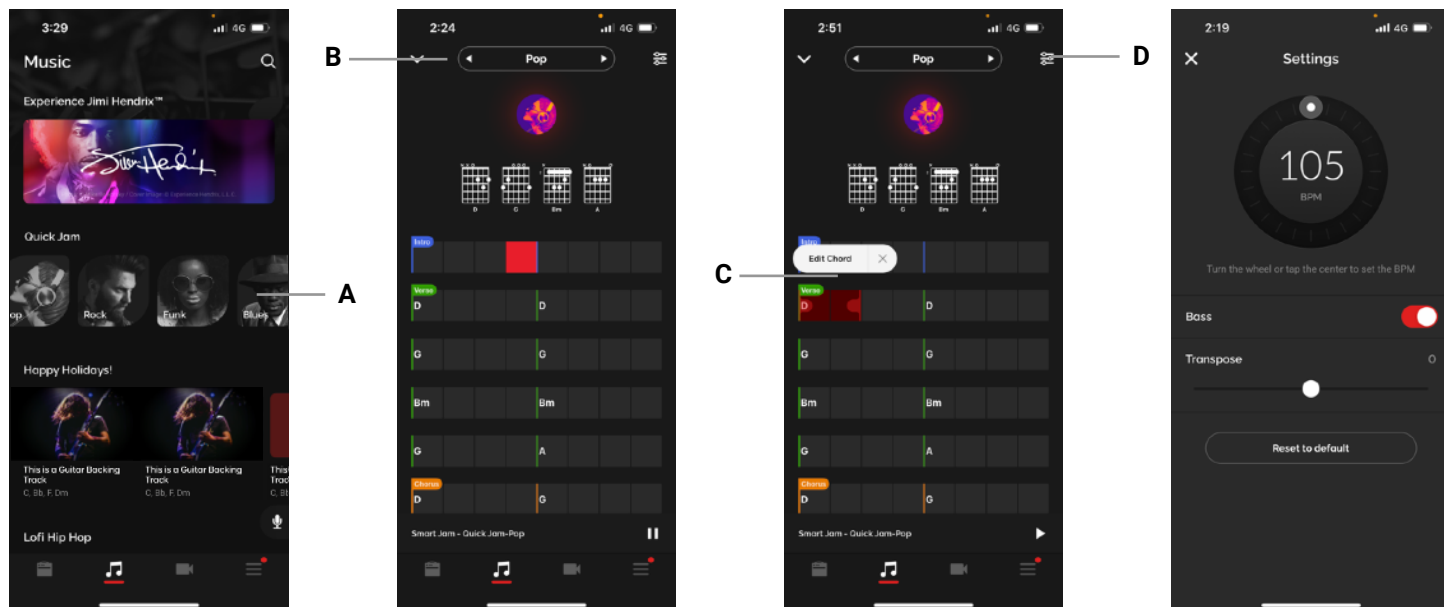

- A. Access Quick Jam by going to the Music page, then scroll the Smart Jam/Quick Jam banner horizontally to see the available genres; Pop, Rock, Funk and Blues. Tap into the genres to start the backing track.
- B. Tap on the left and right arrows next to the genre at the top of the page to switch between the designed tracks for each genre.
- C. Pause the track, then long press a chord to edit the chord, following the same steps as Smart Jam.
- D. Tap on the Settings icon on the top right to adjust settings. The same adjustments in Smart Jam are available here; you may adjust the tempo, turn off the bass, or transpose the track by increments of half steps up to an octave up or down. Tap Reset to default to reset the track to its initial default state.
- E. Any changes made will be automatically saved, and automatically loaded when you load up Quick Jam.

## Using Auto Chords and Tones

Choose any song, and Spark will automatically display its chords in real time as you play. Intuitive controls easily let you slow down the song's tempo or loop a difficult section.

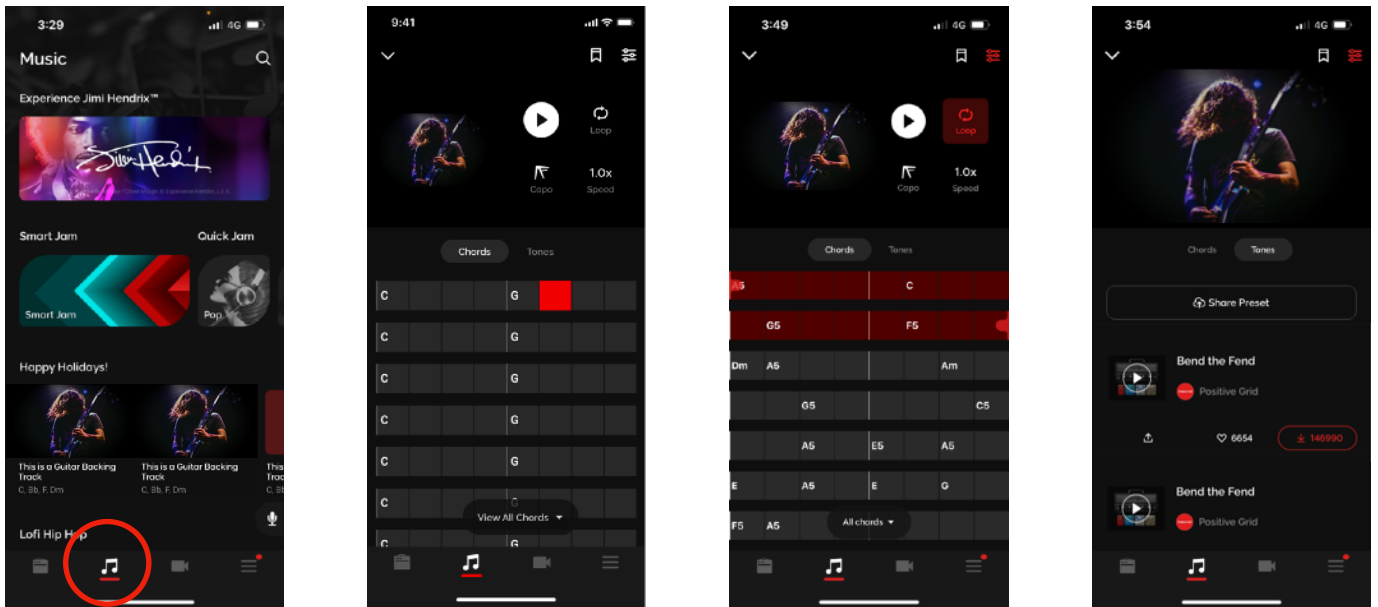

- (A) Go to the Music page and tap on our curated playlists to learn songs from those playlists.
- (B) Search for any song with the search bar at the top of the Music page to learn a song of your choice.
- (C) Tap on the Settings icon on the top right to access Music tools
  1. Tap on Loop and drag the handles to loop the selected section.
  2. Tap on Capo to change the chords to a capo'd version, allowing you to play with standard open chords.
  3. Tap on the Speed button to change the speed of the track to 0.5/0.8/1.0x speed to practice at a slower tempo.
- (D) Tap on Tones to bring up tones that are recommended for the song according to other users. Upload your own ToneCloud presets to contribute to this growing pool of tones!

## Connecting Spotify and Apple Music

Connect your Spotify and Apple Music accounts to import your saved albums to the Spark app.

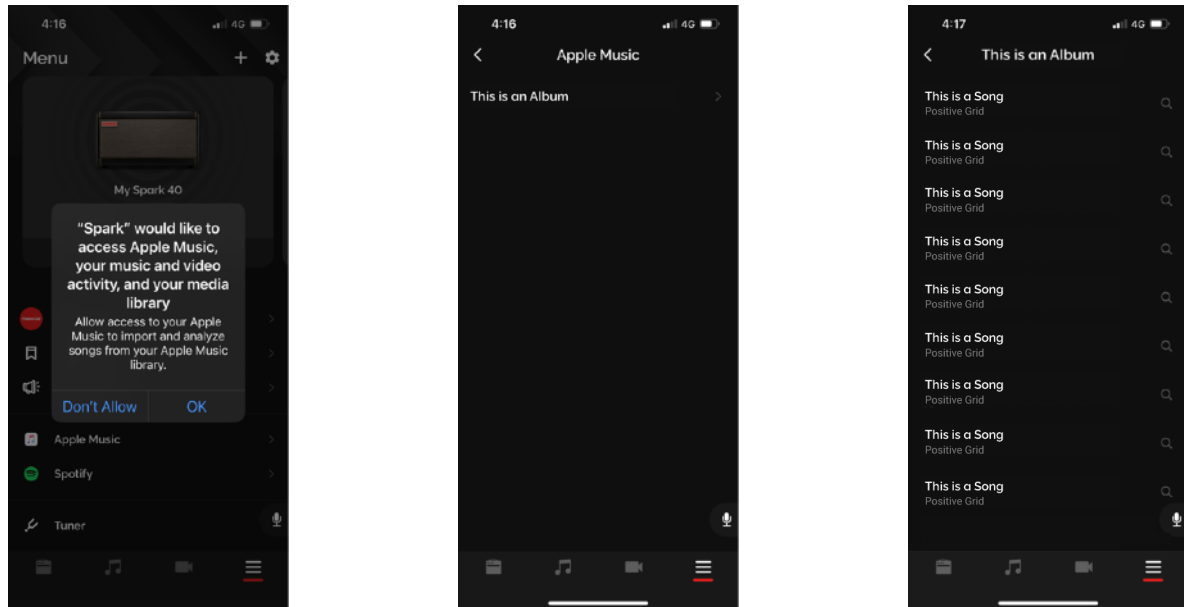

(A) Go to the Menu page and tap on Spotify or Apple Music.

(B) Log in to your Spotify or Apple Music accounts.

(C) Choose the desired album from your Apple Music or Spotify list to import your albums into Saved Songs in the Menu page.

Tip: Make sure that Spark has access to your Spotify or Apple Music account.

## Using Video Recording

Record a video of your guitar playing from within your Spark app to record ideas or covers to share to social media.

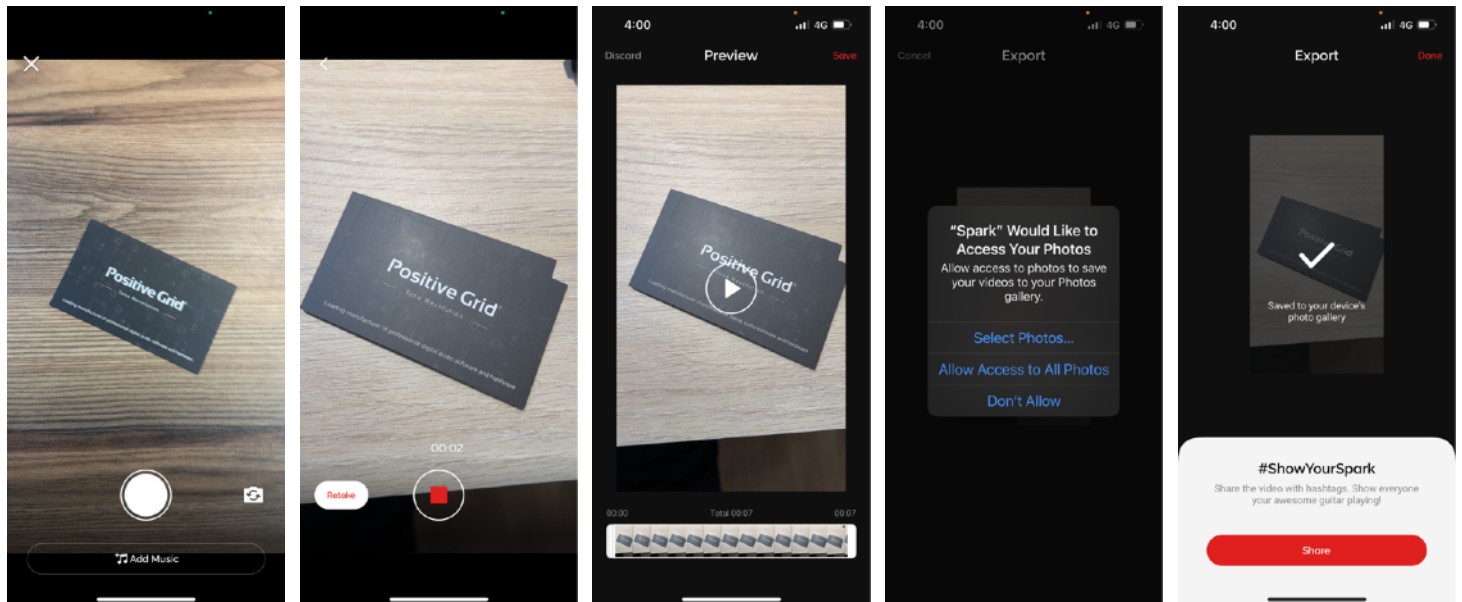

- (A) Tap the Video icon to open the Video Recording function.
- (B) Tap Add music to add a Smart Jam backing track or a locally saved music file to play along to while you record.
- (C) Tap the camera flip icon to switch between the front and back cameras of your device.
- (D) Tap the Record button to start recording, tap again to stop recording.
- (E) Tap Retake to begin another take without stopping your initial video.
- (F) Once you've finished recording your video, you may trim the beginning and end of the video to your desired length in the Preview Screen.
- (G) Tap Save to export the video to your camera roll. Make sure the app has access to your Photo library to save the video.
- (H) Tap share to share to social media or messaging platforms, or Done to continue.

## Using Voice Command

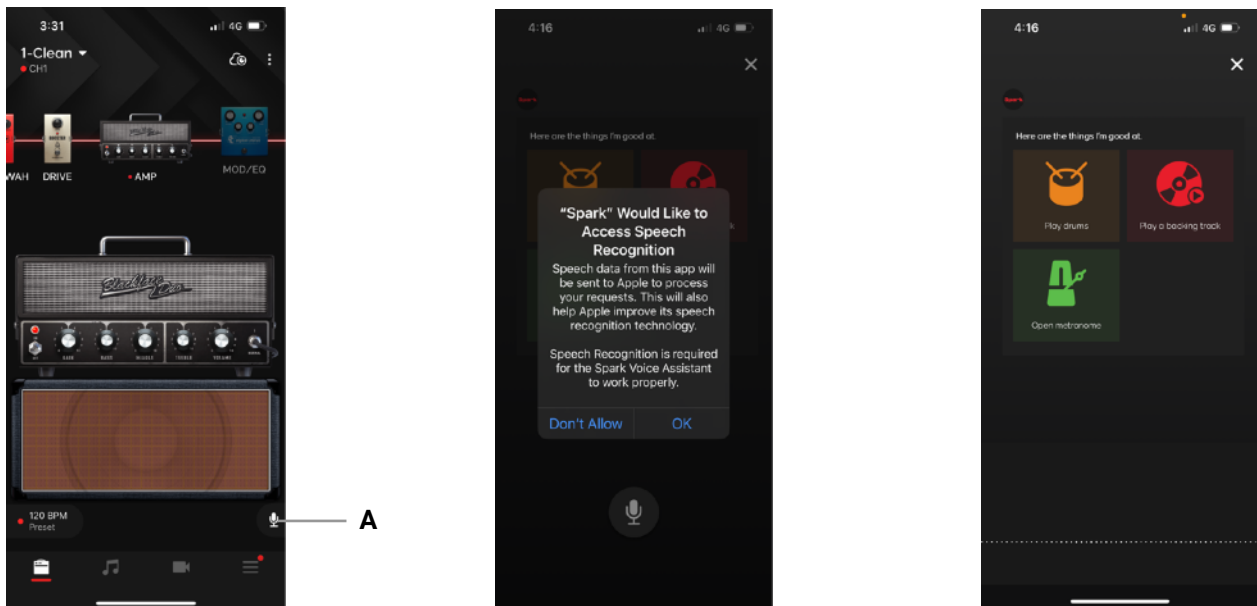

### (A) Music Assistant

1. Tap the microphone icon. It is available in most pages.
2. Make sure to allow permissions for Speech Recognition and your devices Microphone to ensure the feature works properly.
3. Speak into your smartphone with the following voice commands. Alternatively, you can tap the on-screen quick commands.
  1. Play drums - Same as Smart Jam
  2. Play a backing track - Play a custom backing track.
  3. Metronome - Open Spark's built-in metronome

### (B) Voice Command Language Support

1. English
2. Japanese

Tip: The Voice Command feature has three quick commands. Try them!

## Device Card and Adjustments

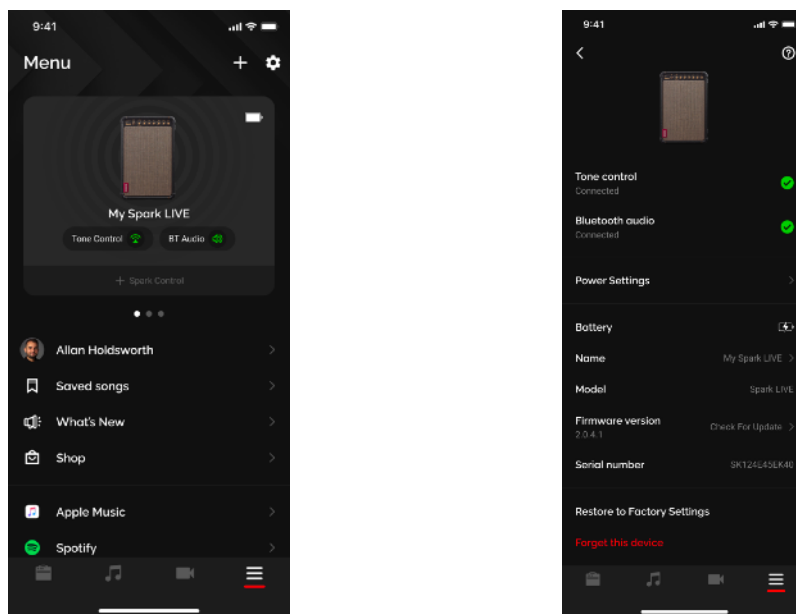

The Device Card can be accessed in the Menu page once you've connected your Spark Amp. Once it's connected, tap on the device at the top of the menu to access your Device Card, where several settings can be adjusted and statuses can be observed.

1. **Tone Control and Bluetooth Audio** - Shows the status of your Bluetooth connections between your device to the Spark Amp
2. **Power Settings** - Power Settings will allow you to adjust Spark LIVE's Auto Standby and Auto Shutdown features to save battery life.

Spark LIVE will automatically enter a low power state after a set amount of time has passed where no audio is detected to preserve battery life. The time it takes to enter standby mode can be adjusted in this menu. While the Spark LIVE is in this state, instrument output and music playback will be temporarily disabled. To enable audio output again, play your plugged in instrument or start audio playback to reactivate it.

3. **Battery** - Displays the battery status of your device.
4. **Name** - Change the display name of your Spark amp when connecting to your Spark.
5. **Model** - Displays the model of your Spark amp.
6. **Firmware** - Displays the firmware version installed on your Spark amp.
7. **Serial Number** - Displays the Serial Number of your Spark amp.
8. **Restore to Factory Settings** - Restores all settings to the factory defaults.
9. **Forget This Device** - Remove this device from your list of connected devices.

## Updating Your Firmware on the Spark LIVE

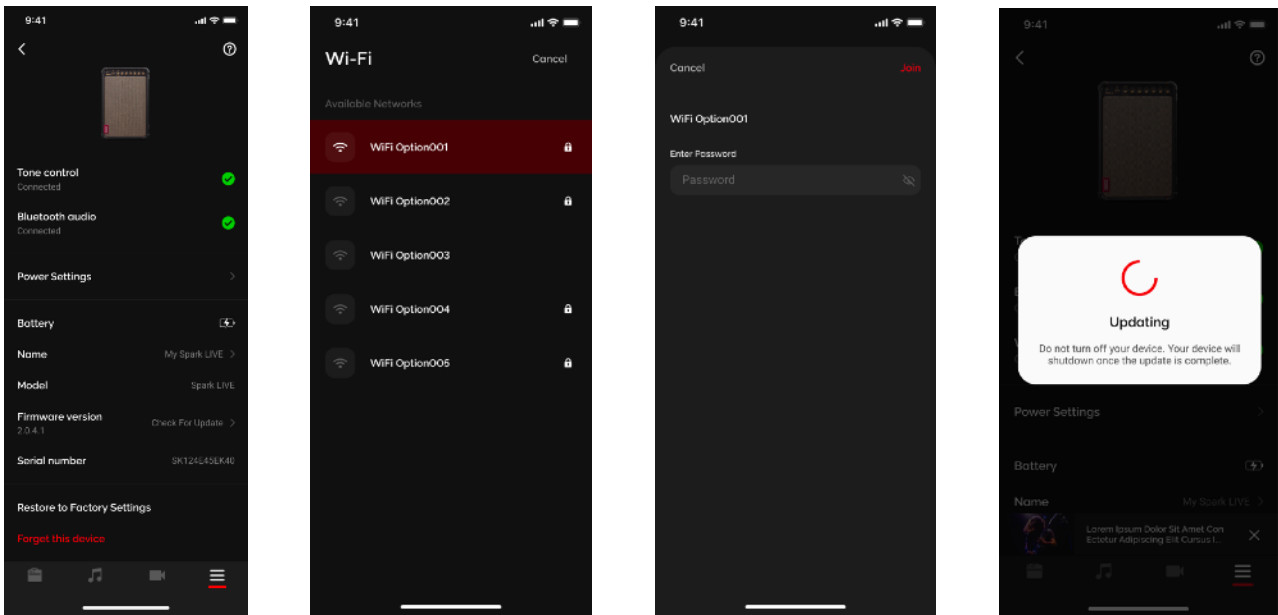

Spark LIVE has the ability to update its firmware via Wi-Fi. Please make sure you are near a Wi-Fi access point with an internet connection and follow the instructions to update your firmware:

### Connecting to Wi-Fi

1. Tap on the “Check for Update” button, a dialog box should appear asking to connect to Wi-Fi
2. Tap Connect. Your Spark LIVE will search for available Wi-Fi access points. Select your access point and enter its password to connect.

### Updating Firmware

1. Go into the device card of the Spark LIVE and tap on Check for Update or Update to update to the latest version.
2. Your device will automatically shutdown once the update is complete. Turn on your device and connect, then double check the Device Card to see whether the firmware update was successful.

## Other Available Functions

### Tuner and Metronome

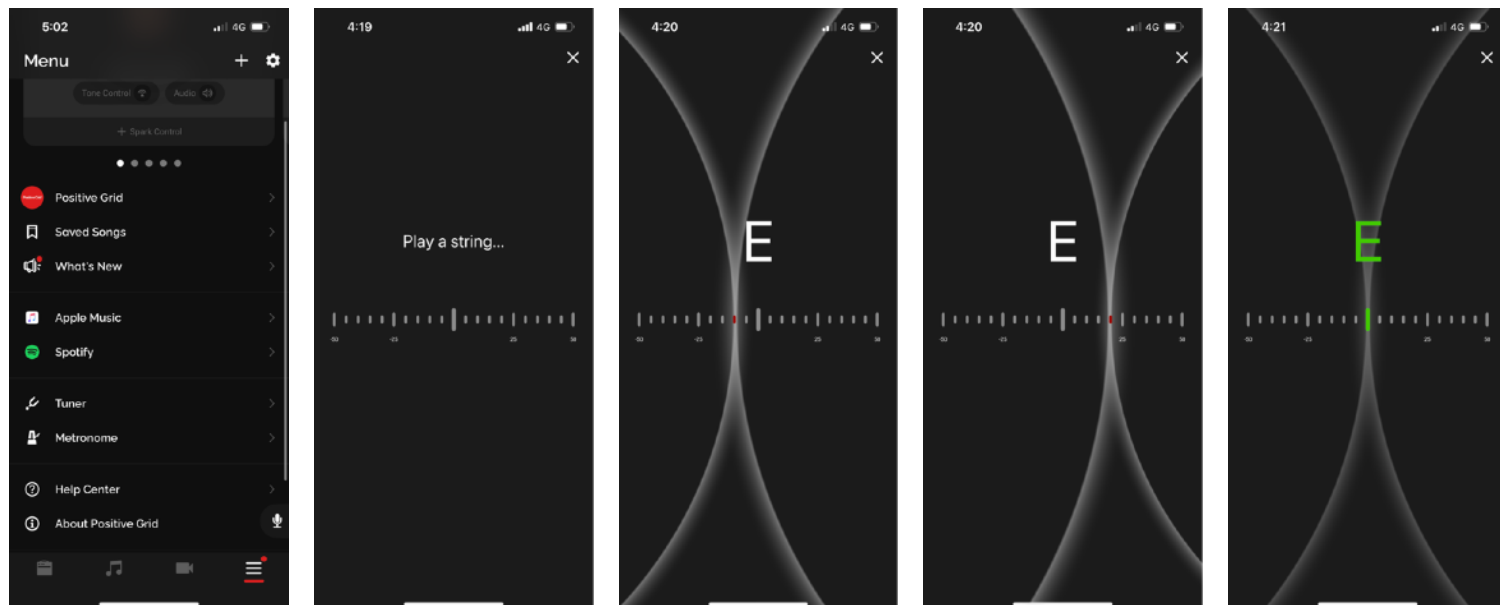

(A) Access the Tuner and Metronome by going to the Menu page and scrolling down, tapping on the desired tool.

(B) Once in the Tuner page, play your instrument to start tuning

1. If the line is to the left of the middle point, your instrument is below the target pitch
2. If the line is to the right of the middle point, your instrument is above the target pitch
3. Once the line is in the middle and the note turns green, the string is in tune and you may move on to tune the other strings to your instrument

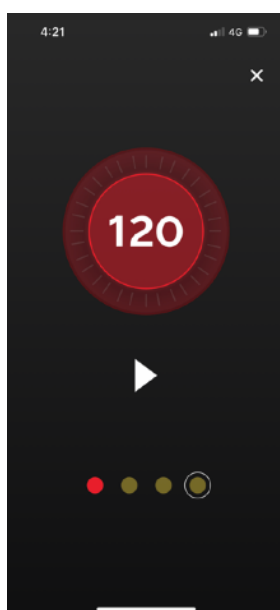

(C) In the Metronome page, tap on the number at your desired tempo to set the tempo. You may also press and turn the outer ring to adjust the tempo. Tap on the play button to start the metronome.

## Other Available Functions

### Back Up Presets to Drop Box

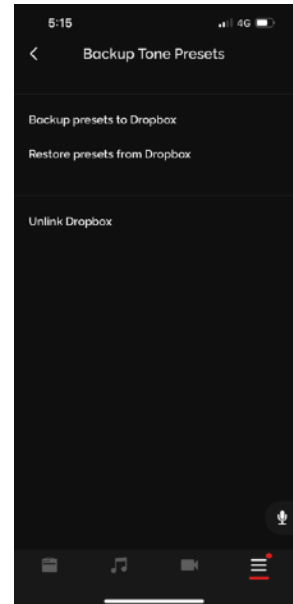
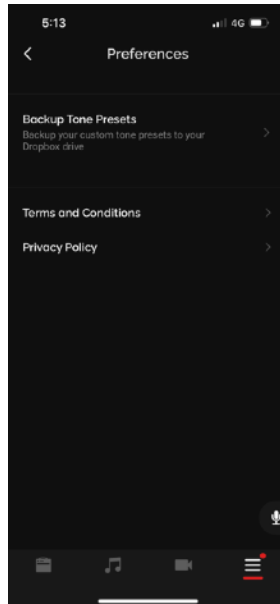
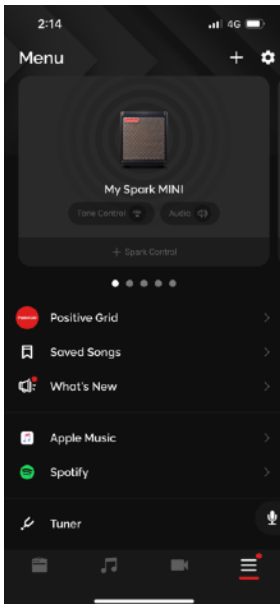

- (A) To Back Up your presets to Drop Box, tap on the  icon at the top right of the Menu page.
- (B) Tap on Backup Tone Presets and link your Drop Box account to the Spark app.
- (C) Once linked, tap on Backup presets to Dropbox to backup your local presets, and tap on Restore presets from Dropbox to restore those presets.

## **Online Support**

Visit our online Help Center for user manuals, FAQs, or to contact our support team.  
Help Center: <https://help.positivegrid.com/>